

Property Map South Bristol Maine

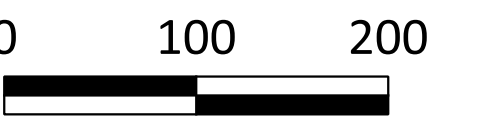
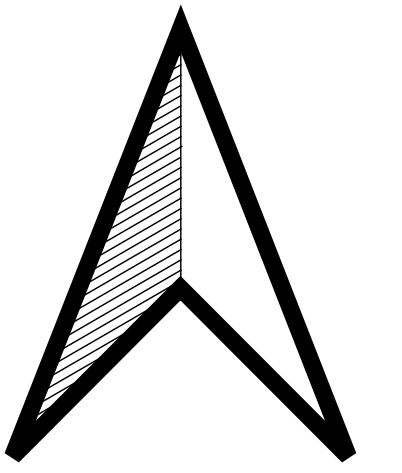

Scale:
1" = 100 ft.

Legend

- Parcels**
- This Map
 - Adjacent Maps
 - Private Roads
 - Public Roads
 - easements
 - Subparcel lines
 - 911_Roads
 - Secondary
 - Local
 - Private
 - Streams
 - NWI_Wetlands
 - Fresh Water Bodies
 - Intertidal Flats and Ledges
 - Tidal Waters

Source Documents:
 South Bristol Property Maps by James W. Sewall Co. and updated through 2014 by Maine Coast Surveying.
 Digital Property Maps prepared by Maine Coast Surveying in 2014 and updated through 2016.
 Digital Property Map updates by Maine Coast Surveying & Flood Consulting 2017 & 2018.
 Digital Property Map updates by Roderick H. Craib, Jr. (PLS 1191) 2019 - 2025.
 Maine Office of Geographic Information Systems digital data layers include:
 High resolution digital orthophotographs produced from aerial photos collected in the Spring of 2013 and 2018.
 Road Type contains Next Generation 9-1-1 road centerline and road name data last updated April 7, 2025.
 Streams depicts single line streams of Maine from USGS 1:24,000 scale quadrangles.
 Wetlands (NWI) contains USFW National Wetland Inventory polygon data for Maine at 1:24,000 scale.
 The tidal shore was developed from two foot contours derived from 2010 -2011 Lidar data courtesy of the USGS and the Maine Office of GIS.

This revision is based only on plans, deeds and other data supplied by the Town of South Bristol.
 Owner's names may be abbreviated, simplified, or omitted to save space. See South Bristol Tax Records for complete names.
 The dimensions and areas shown were derived from this map for assessment purposes only. They may be different from previous tax maps, deeds, or surveys.

**For Assessment Purposes Only
 Not a Boundary Survey
 Not To Be Used For
 Conveyances**

prepared by:
 Roderick H. Craib, Jr.
 Professional Land Surveyor # 1191
 174 Fox Hill Road
 Walpole, ME 04573

Revisions dated April 1, 2026
 Maps printed April 29, 2026

Map 16

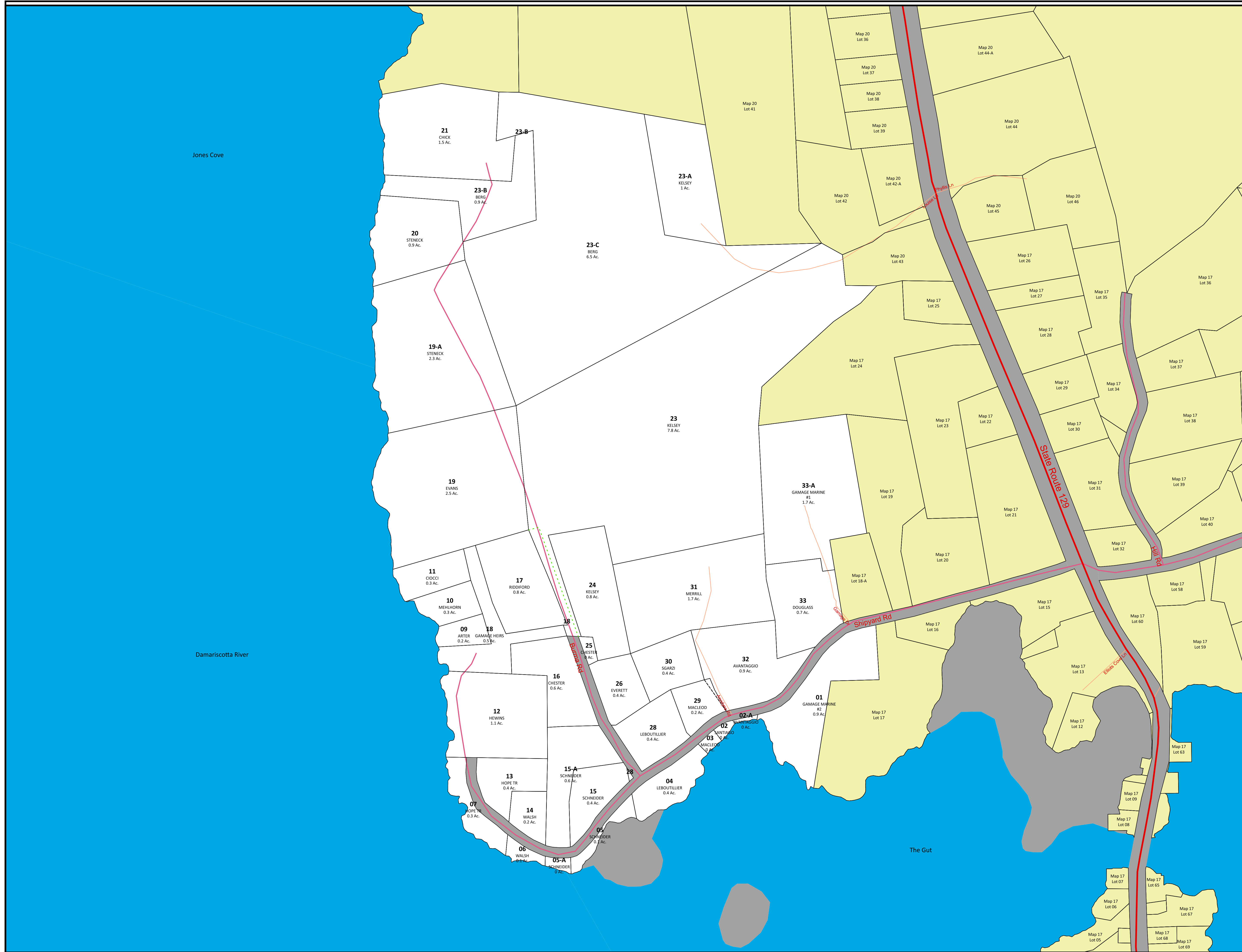

Property Map South Bristol Maine

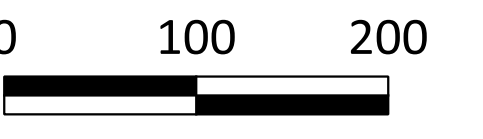
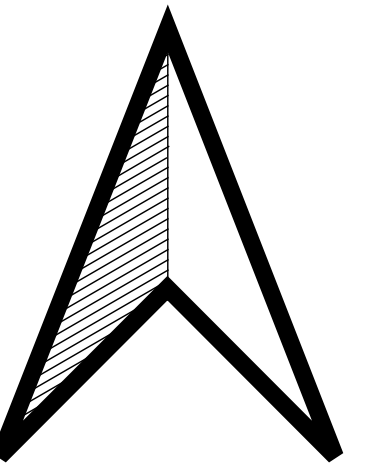

Scale:
1" = 100 ft.

Legend

- Parcels**
- This Map
 - Adjacent Maps
 - Private Roads
 - Public Roads
 - Easements
 - Subparcel lines
 - 911_Roads
 - Secondary
 - Local
 - Private
 - Streams
 - NWI_Wetlands
 - Fresh Water Bodies
 - Intertidal Flats and Ledges
 - Tidal Waters

Source Documents:
 South Bristol Property Maps by James W. Sewall Co. and updated through 2014 by Maine Coast Surveying.
 Digital Property Maps prepared by Maine Coast Surveying in 2014 and updated through 2016.
 Digital Property Map updates by Maine Coast Surveying & Flood Consulting 2017 & 2018.
 Digital Property Map updates by Roderick H. Craib, Jr. (PLS 1191) 2019 - 2025.
 Maine Office of Geographic Information Systems digital data layers include:
 High resolution digital orthophotographs produced from aerial photos collected in the Spring of 2013 and 2018.
 Road Type contains Next Generation 9-1-1 road centerline and road name data last updated April 7, 2025.
 Streams depicts single line streams of Maine from USGS 1:24,000 scale quadrangles.
 Wetlands (NWI) contains USFW National Wetland Inventory polygon data for Maine at 1:24,000 scale.
 The tidal shore was developed from two foot contours derived from 2010 -2011 Lidar data courtesy of the USGS and the Maine Office of GIS.
 This revision is based only on plans, deeds and other data supplied by the Town of South Bristol.
 Owner's names may be abbreviated, simplified, or omitted to save space. See South Bristol Tax Records for complete names.
 The dimensions and areas shown were derived from this map for assessment purposes only. They may be different from previous tax maps, deeds, or surveys.

**For Assessment Purposes Only
 Not a Boundary Survey
 Not To Be Used For
 Conveyances**

prepared by:
 Roderick H. Craib, Jr.
 Professional Land Surveyor # 1191
 174 Fox Hill Road
 Walpole, ME 04573
 Revisions dated April 1, 2026
 Maps printed April 29, 2026

Map 17

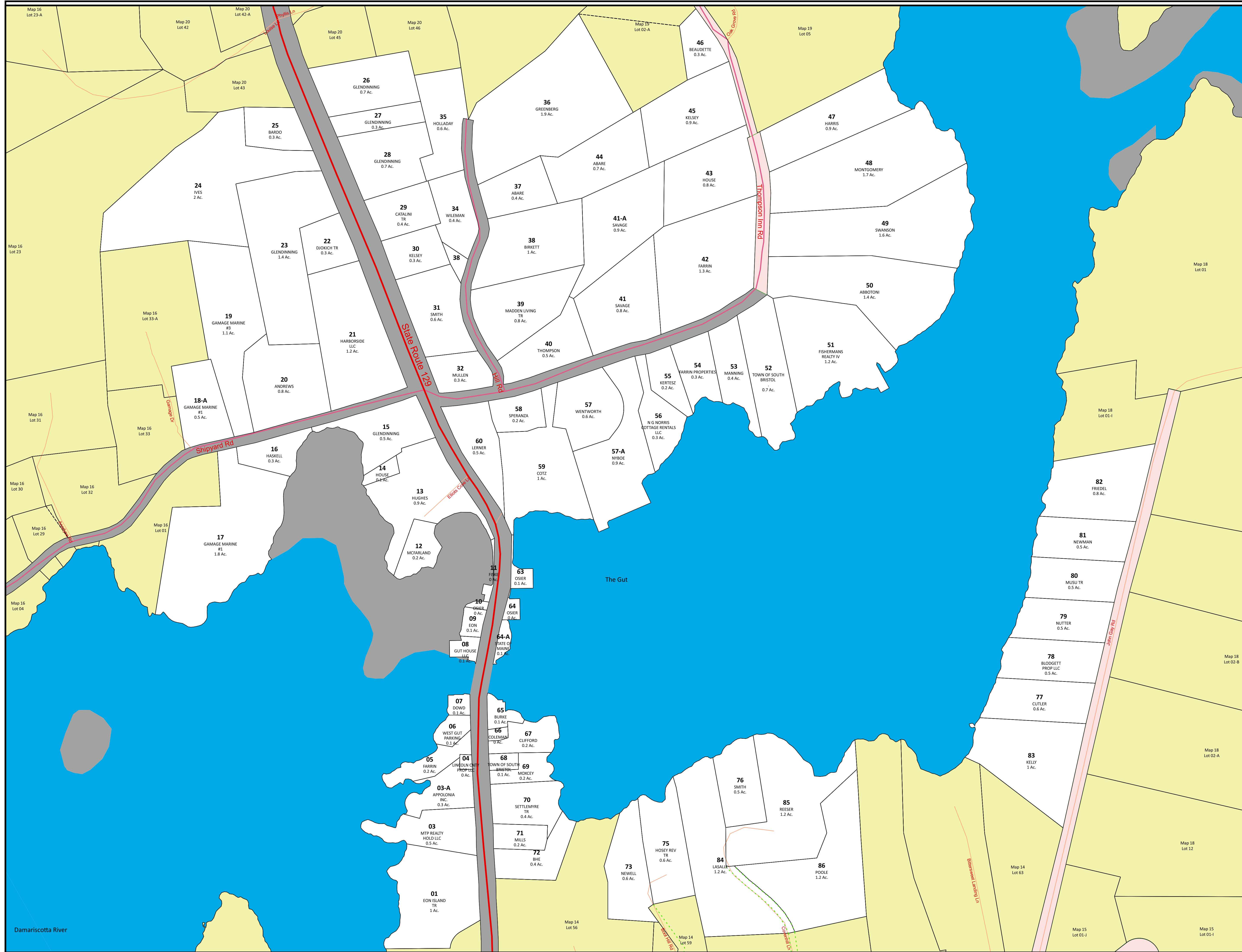

Property Map South Bristol Maine

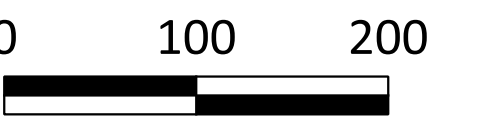
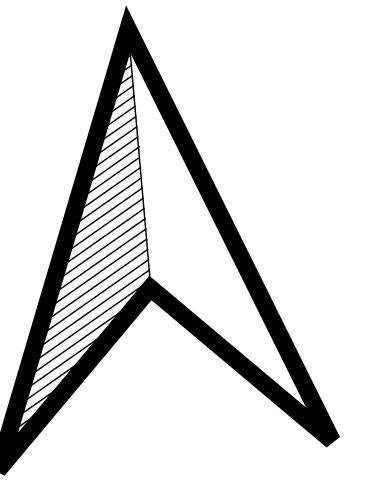

Scale:
1" = 100 ft.

Legend

- Parcels**
- This Map
 - Adjacent Maps
 - Private Roads
 - Public Roads
 - easements
 - Subparcel lines
 - 911_Roads
 - Secondary
 - Local
 - Private
 - Streams
 - NWI_Wetlands
 - Fresh Water Bodies
 - Intertidal Flats and Ledges
 - Tidal Waters

Source Documents:
 South Bristol Property Maps by James W. Sewall Co. and updated through 2014 by Maine Coast Surveying.
 Digital Property Maps prepared by Maine Coast Surveying in 2014 and updated through 2016.
 Digital Property Map updates by Maine Coast Surveying & Flood Consulting 2017 & 2018.
 Digital Property Map updates by Roderick H. Craib, Jr. (PLS 1191) 2019 - 2025.
 Maine Office of Geographic Information Systems digital data layers include:
 High resolution digital orthophotographs produced from aerial photos collected in the Spring of 2013 and 2018.
 Road Type contains Next Generation 9-1-1 road centerline and road name data last updated April 7, 2025.
 Streams depicts single line streams of Maine from USGS 1:24,000 scale quadrangles.
 Wetlands (NWI) contains USFW National Wetland Inventory polygon data for Maine at 1:24,000 scale.
 The tidal shore was developed from two foot contours derived from 2010 -2011 Lidar data courtesy of the USGS and the Maine Office of GIS.
 This revision is based only on plans, deeds and other data supplied by the Town of South Bristol.
 Owner's names may be abbreviated, simplified, or omitted to save space. See South Bristol Tax Records for complete names.
 The dimensions and areas shown were derived from this map for assessment purposes only. They may be different from previous tax maps, deeds, or surveys.

**For Assessment Purposes Only
 Not a Boundary Survey
 Not To Be Used For
 Conveyances**

prepared by:
 Roderick H. Craib, Jr.
 Professional Land Surveyor # 1191
 174 Fox Hill Road
 Walpole, ME 04573
 Revisions dated April 1, 2026
 Maps printed April 29, 2026

Map 18

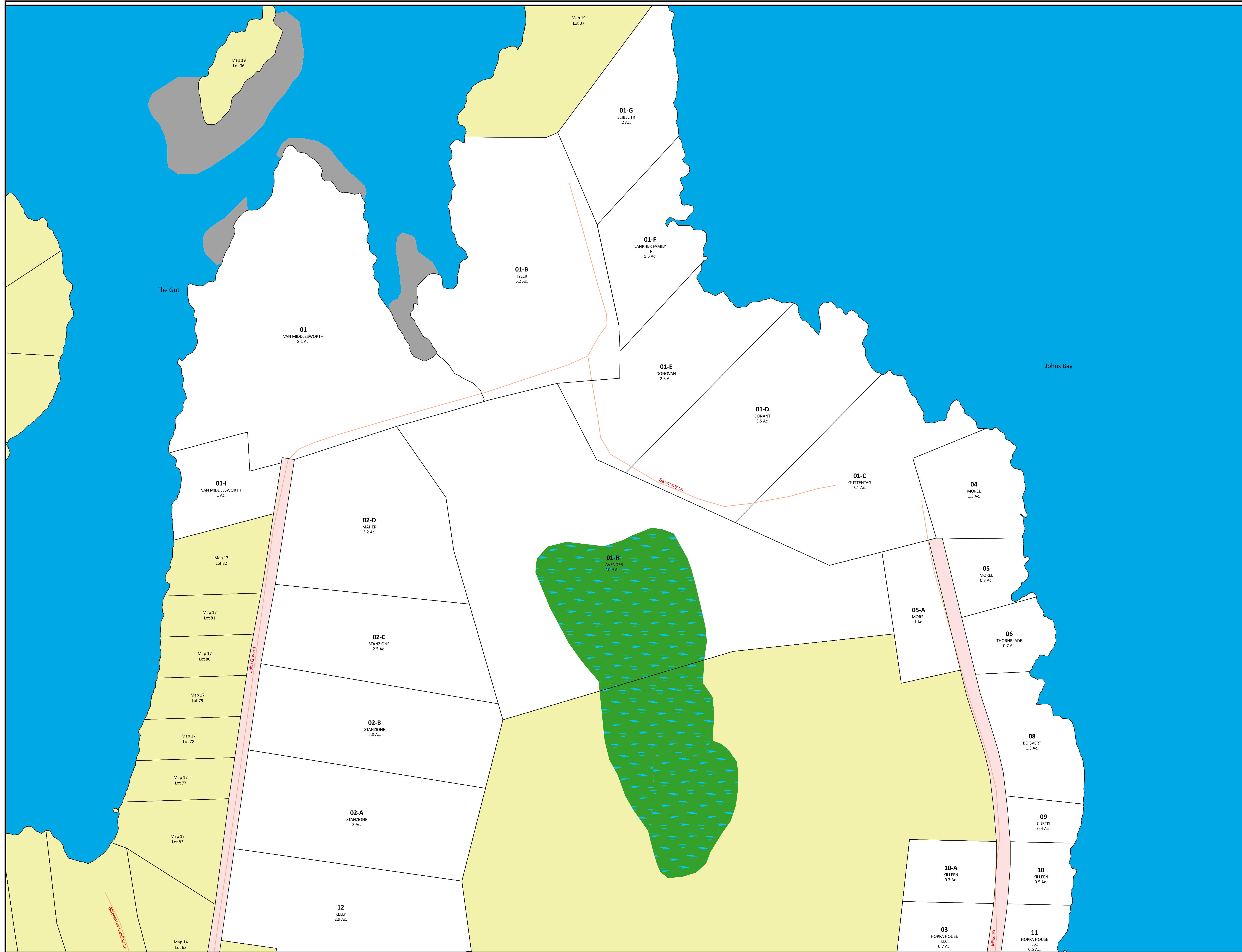

Property Map South Bristol Maine

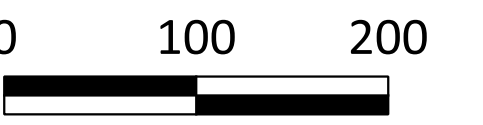
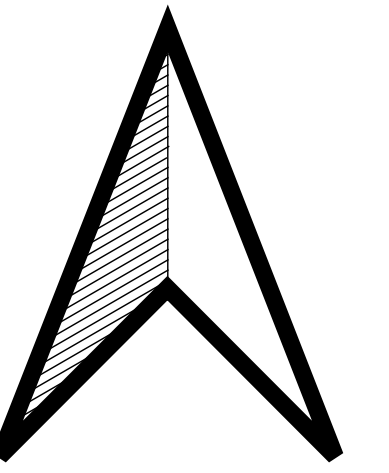

Scale:
1" = 100 ft.

Legend

- Parcels**
- This Map
 - Adjacent Maps
 - Private Roads
 - Public Roads
 - easements
 - Subparcel lines
 - 911_Roads
 - Secondary
 - Local
 - Private
 - Streams
 - NWI_Wetlands
 - Fresh Water Bodies
 - Intertidal Flats and Ledges
 - Tidal Waters

Source Documents:

South Bristol Property Maps by James W. Sewall Co. and updated through 2014 by Maine Coast Surveying.

Digital Property Maps prepared by Maine Coast Surveying in 2014 and updated through 2016.

Digital Property Map updates by Maine Coast Surveying & Flood Consulting 2017 & 2018.

Digital Property Map updates by Roderick H. Craib, Jr. (PLS 1191) 2019 - 2025.

Maine Office of Geographic Information Systems digital data layers include:

High resolution digital orthophotographs produced from aerial photos collected in the Spring of 2013 and 2018.

Road Type contains Next Generation 9-1-1 road centerline and road name data last updated April 7, 2026.

Streams depicts single line streams of Maine from USGS 1:24,000 scale quadrangles.

Wetlands (NWI) contains USFW National Wetland Inventory polygon data for Maine at 1:24,000 scale.

The tidal shore was developed from two foot contours derived from 2010 -2011 Lidar data courtesy of the USGS and the Maine Office of GIS.

This revision is based only on plans, deeds and other data supplied by the Town of South Bristol.

Owner's names may be abbreviated, simplified, or omitted to save space. See South Bristol Tax Records for complete names.

The dimensions and areas shown were derived from this map for assessment purposes only. They may be different from previous tax maps, deeds, or surveys.

**For Assessment Purposes Only
Not a Boundary Survey
Not To Be Used For
Conveyances**

prepared by:
Roderick H. Craib, Jr.
Professional Land Surveyor # 1191
174 Fox Hill Road
Walpole, ME 04573

Revisions dated April 1, 2026
Maps printed April 29, 2026

Map 19

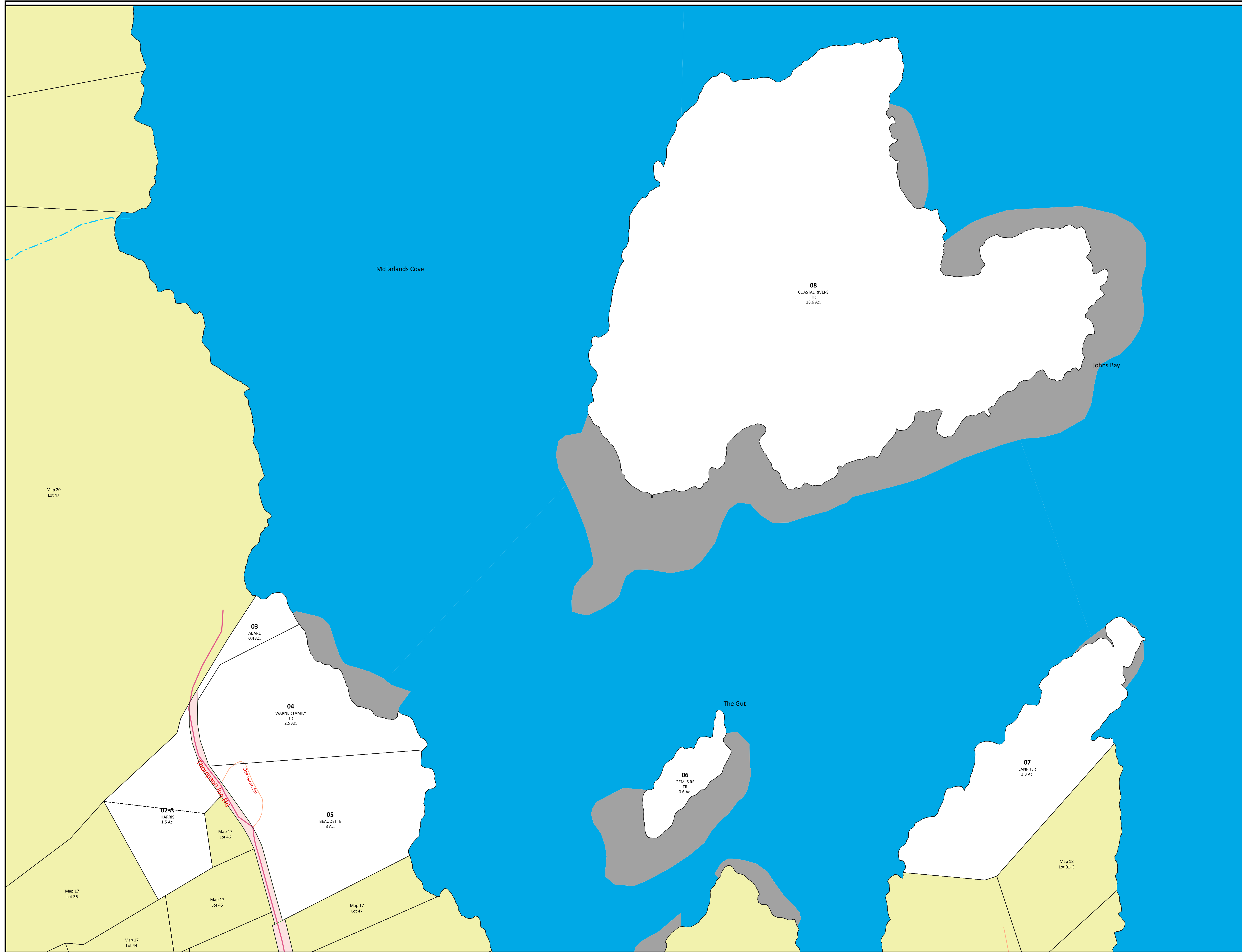

Map 20
Lot 47

Map 17
Lot 36

Map 17
Lot 44

Map 17
Lot 45

Map 17
Lot 47

Map 18
Lot 01-G

Property Map South Bristol Maine

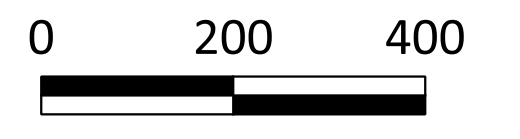
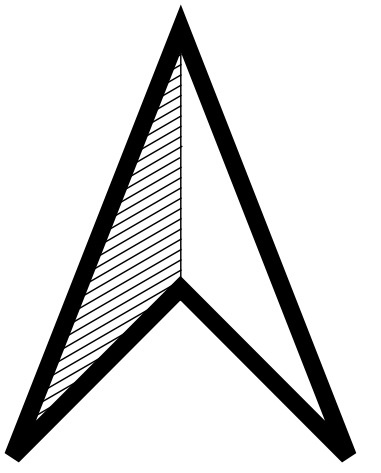

Scale:
1" = 200 ft.

Legend

- Parcels**
- This Map
 - Adjacent Maps
 - Private Roads
 - Public Roads
 - Easements
 - Subparcel lines
 - 911_Roads
 - Secondary
 - Local
 - Private
 - Streams
 - NWI_Wetlands
 - Fresh Water Bodies
 - Intertidal Flats and Ledges
 - Tidal Waters

Source Documents:
 South Bristol Property Maps by James W. Sewall Co. and updated through 2014 by Maine Coast Surveying.
 Digital Property Maps prepared by Maine Coast Surveying in 2014 and updated through 2016.
 Digital Property Map updates by Maine Coast Surveying & Flood Consulting 2017 & 2018.
 Digital Property Map updates by Roderick H. Craib, Jr. (PLS 1191) 2019 - 2025.
 Maine Office of Geographic Information Systems digital data layers include:
 High resolution digital orthophotographs produced from aerial photos collected in the Spring of 2013 and 2018.
 Road Type contains Next Generation 9-1-1 road centerline and road name data last updated April 7, 2025.
 Streams depicts single line streams of Maine from USGS 1:24,000 scale quadrangles.
 Wetlands (NWI) contains USFW National Wetland Inventory polygon data for Maine at 1:24,000 scale.
 The tidal shore was developed from two foot contours derived from 2010 - 2011 Lidar data courtesy of the USGS and the Maine Office of GIS.

This revision is based only on plans, deeds and other data supplied by the Town of South Bristol.
 Owner's names may be abbreviated, simplified, or omitted to save space. See South Bristol Tax Records for complete names.
 The dimensions and areas shown were derived from this map for assessment purposes only. They may be different from previous tax maps, deeds, or surveys.

**For Assessment Purposes Only
 Not a Boundary Survey
 Not To Be Used For
 Conveyances**

prepared by:
 Roderick H. Craib, Jr.
 Professional Land Surveyor # 1191
 174 Fox Hill Road
 Walpole, ME 04573
 Revisions dated April 1, 2026
 Maps printed April 29, 2026

Map 20

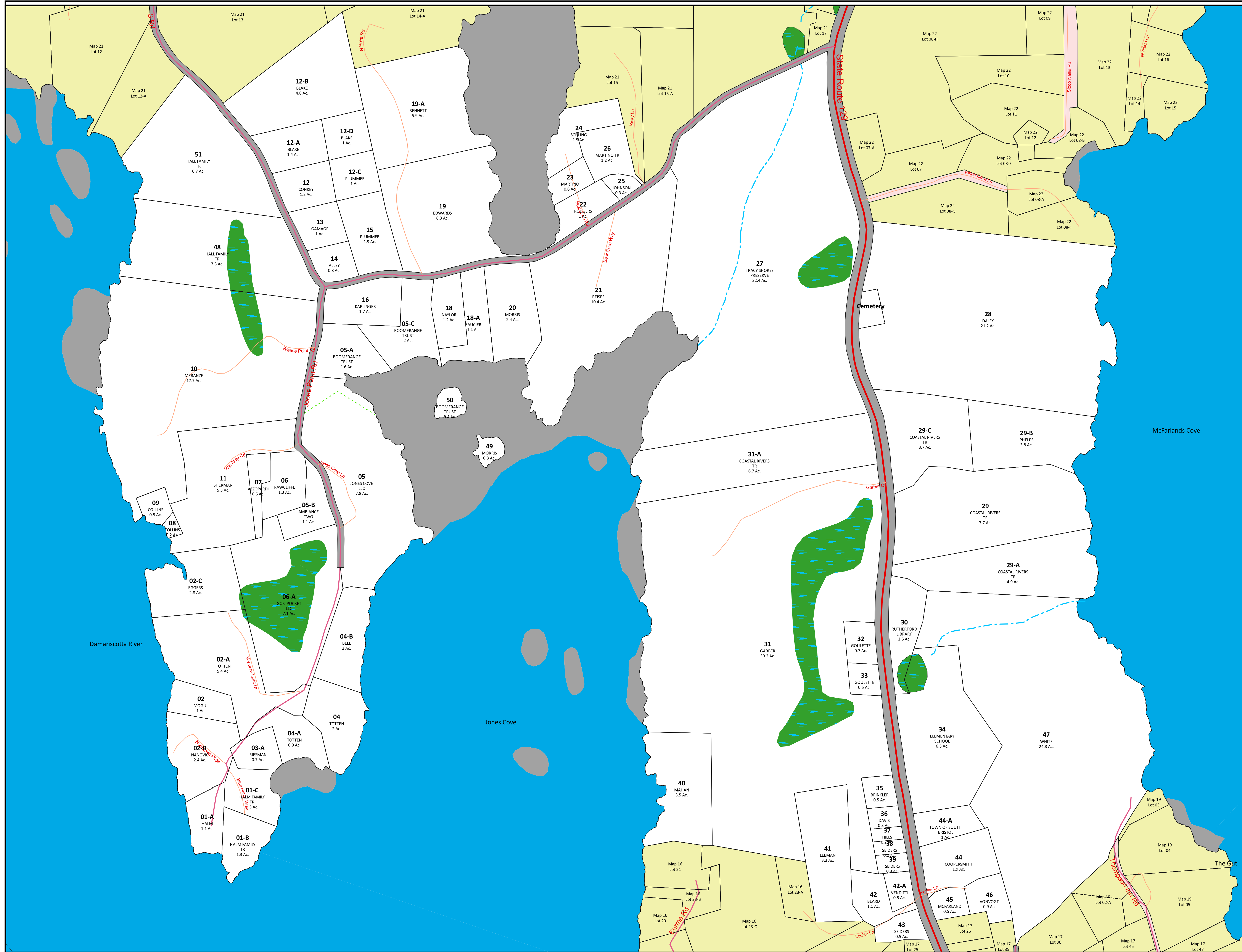

Property Map South Bristol Maine

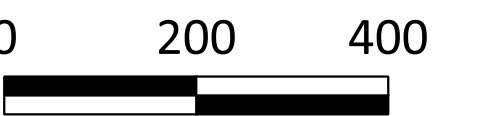
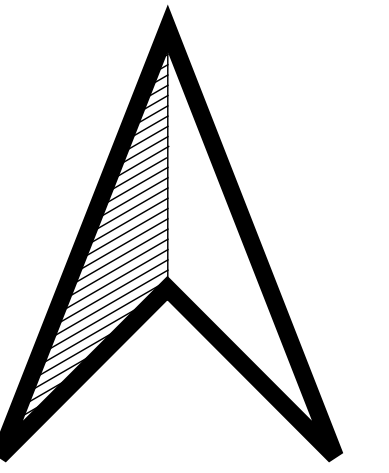

Scale:
1" = 200 ft.

Legend

- Parcels**
- This Map
 - Adjacent Maps
 - Private Roads
 - Public Roads
 - easements
 - Subparcel lines
 - 911_Roads
 - Secondary
 - Local
 - Private
 - Streams
 - NWI_Wetlands
 - Fresh Water Bodies
 - Intertidal Flats and Ledges
 - Tidal Waters

Source Documents:
 South Bristol Property Maps by James W. Sewall Co. and updated through 2014 by Maine Coast Surveying.
 Digital Property Maps prepared by Maine Coast Surveying in 2014 and updated through 2016.
 Digital Property Map updates by Maine Coast Surveying & Flood Consulting 2017 & 2018.
 Digital Property Map updates by Roderick H. Craib, Jr. (PLS 1191) 2019 - 2025.
 Maine Office of Geographic Information Systems digital data layers include:
 High resolution digital orthophotographs produced from aerial photos collected in the Spring of 2013 and 2018.
 Road Type contains Next Generation 9-1-1 road centerline and road name data last updated April 7, 2025.
 Streams depicts single line streams of Maine from USGS 1:24,000 scale quadrangles.
 Wetlands (NWI) contains USFW National Wetland Inventory polygon data for Maine at 1:24,000 scale.
 The tidal shore was developed from two foot contours derived from 2010 -2011 Lidar data courtesy of the USGS and the Maine Office of GIS.

This revision is based only on plans, deeds and other data supplied by the Town of South Bristol.
 Owner's names may be abbreviated, simplified, or omitted to save space. See South Bristol Tax Records for complete names.
 The dimensions and areas shown were derived from this map for assessment purposes only. They may be different from previous tax maps, deeds, or surveys.

**For Assessment Purposes Only
 Not a Boundary Survey
 Not To Be Used For
 Conveyances**

prepared by:
 Roderick H. Craib, Jr.
 Professional Land Surveyor # 1191
 174 Fox Hill Road
 Walpole, ME 04573
 Revisions dated April 1, 2026
 Maps printed April 29, 2026

Map 21

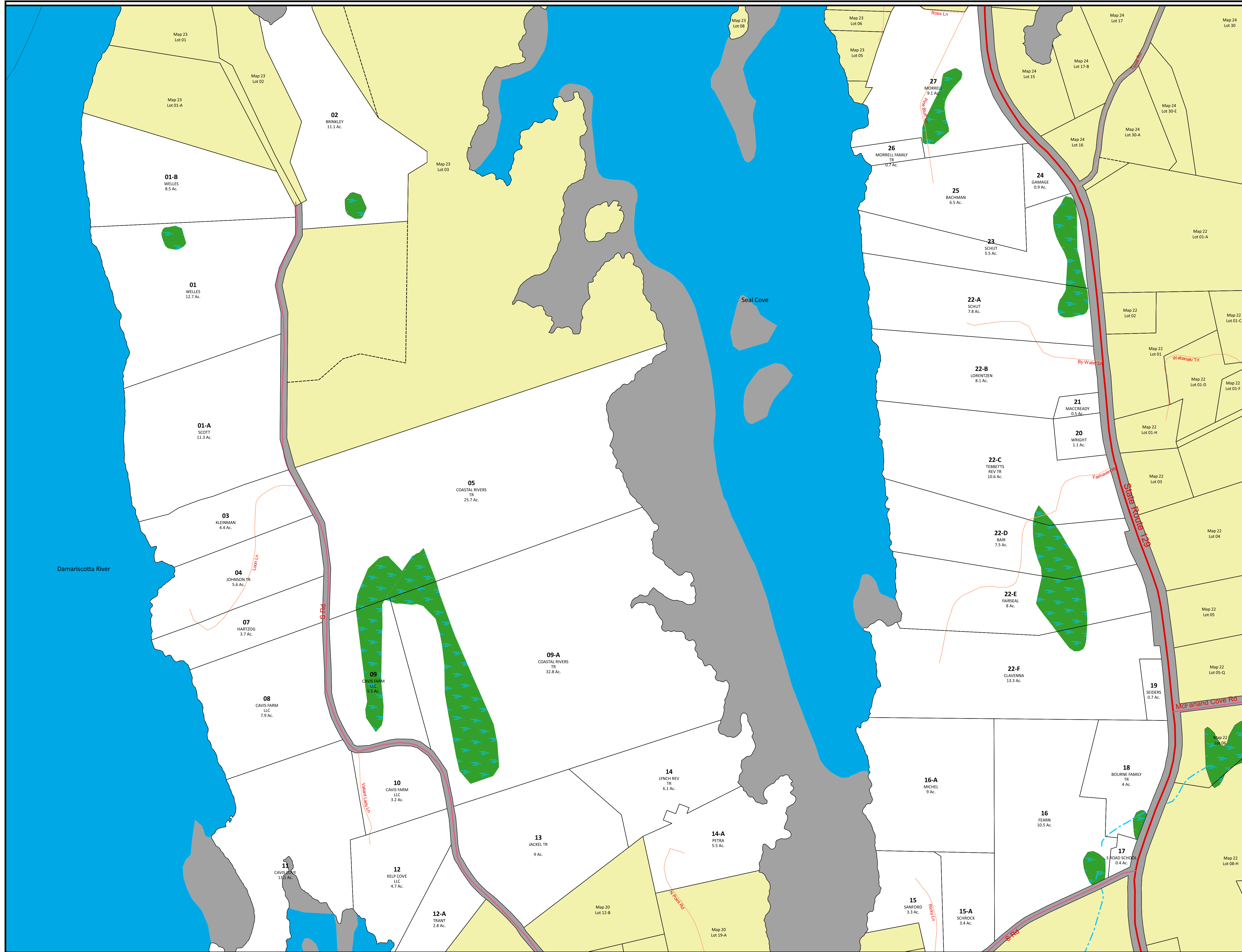

Property Map South Bristol Maine

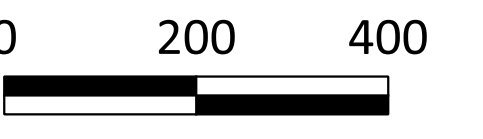
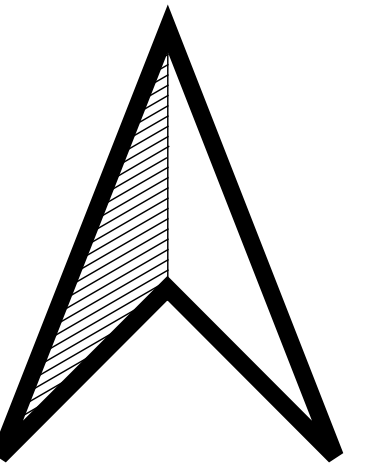

Scale:
1" = 200 ft.

Legend

- Parcels**
- This Map
 - Adjacent Maps
 - Private Roads
 - Public Roads
 - Easements
 - Subparcel lines
 - 911_Roads
 - Secondary
 - Local
 - Private
 - Streams
 - NWI_Wetlands
 - Fresh Water Bodies
 - Intertidal Flats and Ledges
 - Tidal Waters

Source Documents:
 South Bristol Property Maps by James W. Sewall Co. and updated through 2014 by Maine Coast Surveying.
 Digital Property Maps prepared by Maine Coast Surveying in 2014 and updated through 2016.
 Digital Property Map updates by Maine Coast Surveying & Flood Consulting 2017 & 2018.
 Digital Property Map updates by Roderick H. Craib, Jr. (PLS 1191) 2019 - 2025.
 Maine Office of Geographic Information Systems digital data layers include:
 High resolution digital orthophotographs produced from aerial photos collected in the Spring of 2013 and 2018.
 Road Type contains Next Generation 9-1-1 road centerline and road name data last updated April 7, 2025.
 Streams depicts single line streams of Maine from USGS 1:24,000 scale quadrangles.
 Wetlands (NWI) contains USFWS National Wetland Inventory polygon data for Maine at 1:24,000 scale.
 The tidal shore was developed from two foot contours derived from 2010 - 2011 Lidar data courtesy of the USGS and the Maine Office of GIS.
 This revision is based only on plans, deeds and other data supplied by the Town of South Bristol.
 Owner's names may be abbreviated, simplified, or omitted to save space. See South Bristol Tax Records for complete names.
 The dimensions and areas shown were derived from this map for assessment purposes only. They may be different from previous tax maps, deeds, or surveys.

**For Assessment Purposes Only
 Not a Boundary Survey
 Not To Be Used For
 Conveyances**

prepared by:
 Roderick H. Craib, Jr.
 Professional Land Surveyor # 1191
 174 Fox Hill Road
 Walpole, ME 04573
 Revisions dated April 1, 2026
 Maps printed April 29, 2026

Map 22

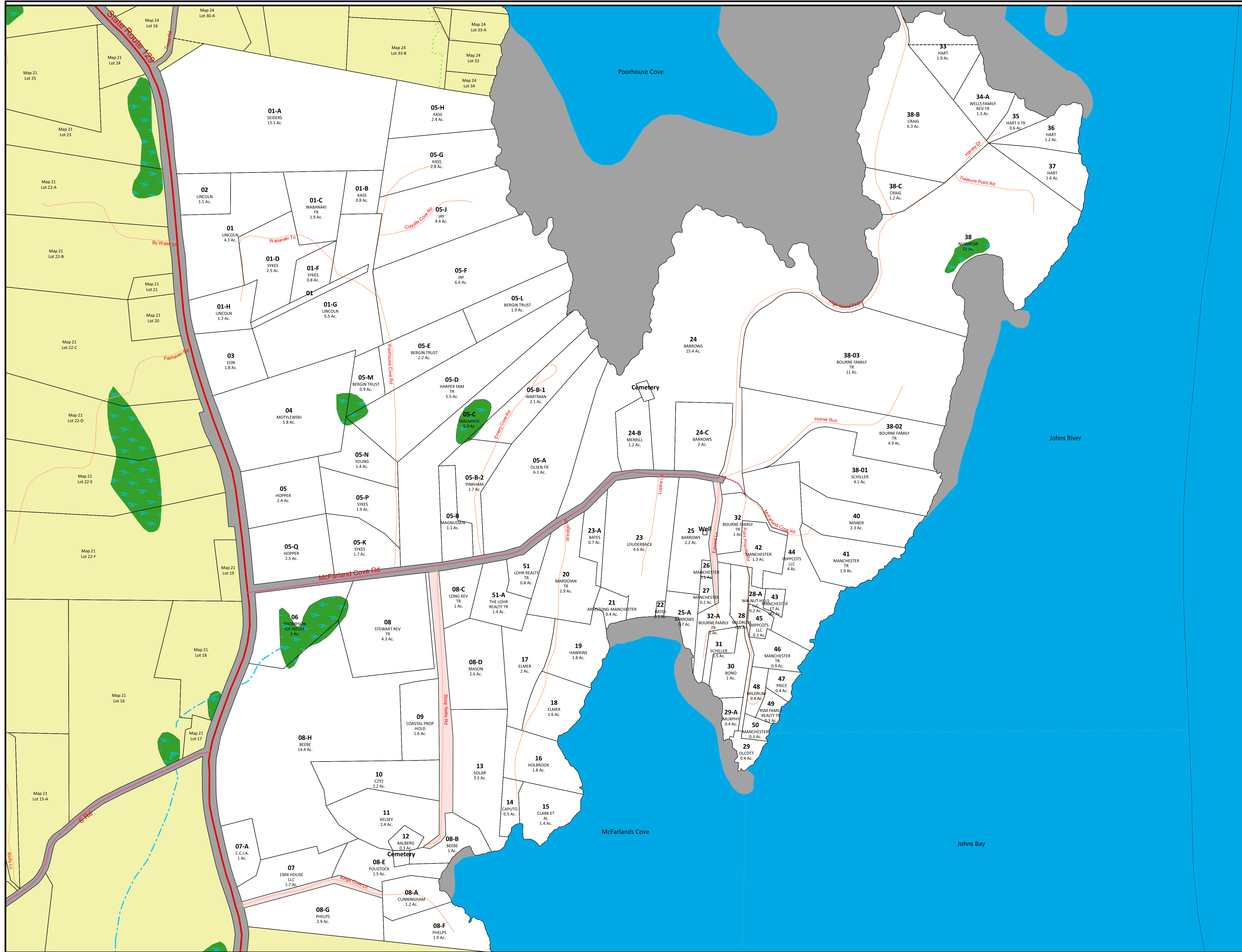

Property Map South Bristol Maine

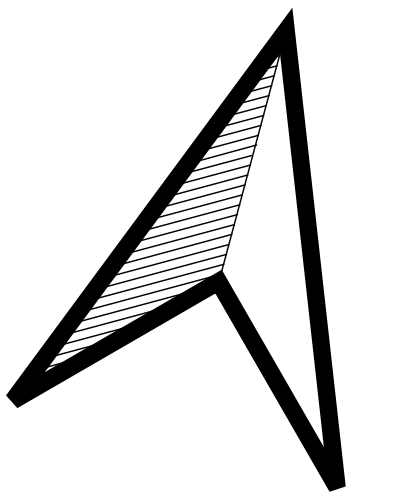

0 200 400

Scale:
1" = 200 ft.

Legend

- Parcels**
- This Map
 - Adjacent Maps
 - Private Roads
 - Public Roads
 - easements
 - Subparcel lines
 - 911_Roads
 - Secondary
 - Local
 - Private
 - Streams
 - NWI_Wetlands
 - Fresh Water Bodies
 - Intertidal Flats and Ledges
 - Tidal Waters

Source Documents:

South Bristol Property Maps by James W. Sewall Co. and updated through 2014 by Maine Coast Surveying.

Digital Property Maps prepared by Maine Coast Surveying in 2014 and updated through 2016.

Digital Property Map updates by Maine Coast Surveying & Flood Consulting 2017 & 2018.

Digital Property Map updates by Roderick H. Craib, Jr. (PLS 1191) 2019 - 2025.

Maine Office of Geographic Information Systems digital data layers include:

High resolution digital orthophotographs produced from aerial photos collected in the Spring of 2013 and 2018.

Road Type contains Next Generation 9-1-1 road centerline and road name data last updated April 7, 2025.

Streams depicts single line streams of Maine from USGS 1:24,000 scale quadrangles.

Wetlands (NWI) contains USFW National Wetland Inventory polygon data for Maine at 1:24,000 scale.

The tidal shore was developed from two foot contours derived from 2010 -2011 Lidar data courtesy of the USGS and the Maine Office of GIS.

This revision is based only on plans, deeds and other data supplied by the Town of South Bristol.

Owner's names may be abbreviated, simplified, or omitted to save space. See South Bristol Tax Records for complete names.

The dimensions and areas shown were derived from this map for assessment purposes only. They may be different from previous tax maps, deeds, or surveys.

**For Assessment Purposes Only
Not a Boundary Survey
Not To Be Used For
Conveyances**

prepared by:
Roderick H. Craib, Jr.
Professional Land Surveyor # 1191
174 Fox Hill Road
Walpole, ME 04573

Revisions dated April 1, 2026
Maps printed April 29, 2026

Map 23

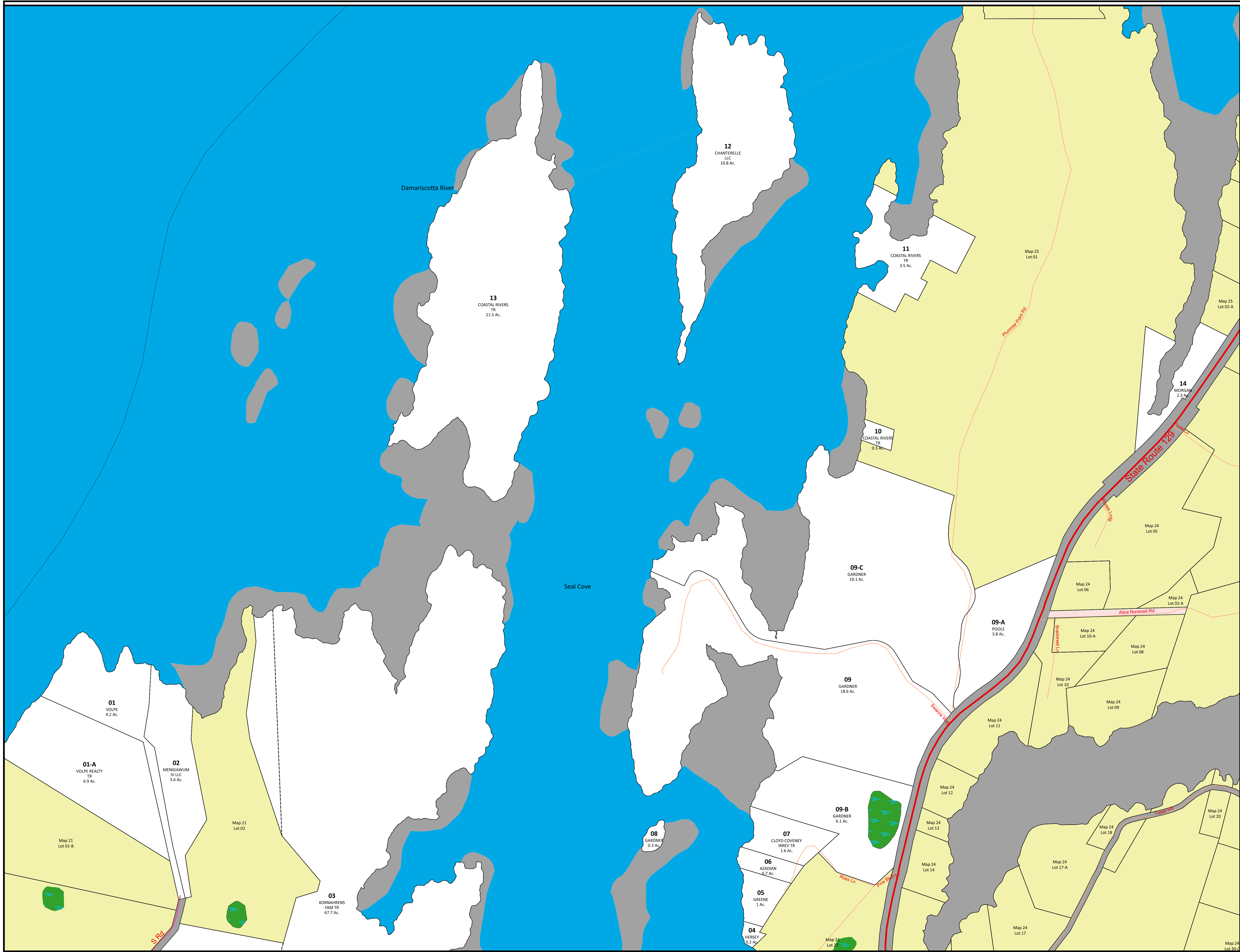

Property Map South Bristol Maine

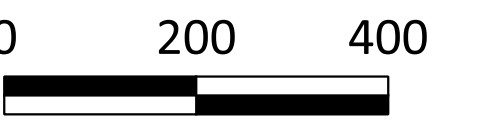
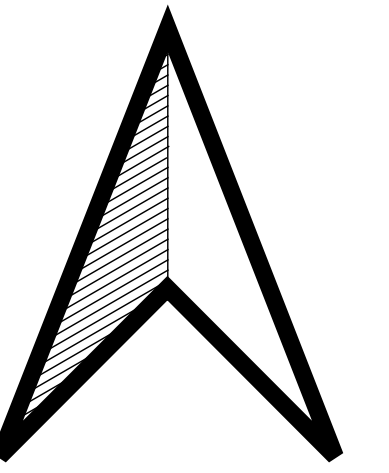

Scale:
1" = 200 ft.

Legend

- Parcels**
- This Map
 - Adjacent Maps
 - Private Roads
 - Public Roads
 - easements
 - Subparcel lines
 - 911_Roads
 - Secondary
 - Local
 - Private
 - Streams
 - NWI_Wetlands
 - Fresh Water Bodies
 - Intertidal Flats and Ledges
 - Tidal Waters

Source Documents:
 South Bristol Property Maps by James W. Sewall Co. and updated through 2014 by Maine Coast Surveying.
 Digital Property Maps prepared by Maine Coast Surveying in 2014 and updated through 2016.
 Digital Property Map updates by Maine Coast Surveying & Flood Consulting 2017 & 2018.
 Digital Property Map updates by Roderick H. Craib, Jr. (PLS 1191) 2019 - 2025.
 Maine Office of Geographic Information Systems digital data layers include:
 High resolution digital orthophotographs produced from aerial photos collected in the Spring of 2013 and 2018.
 Road Type contains Next Generation 9-1-1 road centerline and road name data last updated April 7, 2025.
 Streams depicts single line streams of Maine from USGS 1:24,000 scale quadrangles.
 Wetlands (NWI) contains USFW National Wetland Inventory polygon data for Maine at 1:24,000 scale.
 The tidal shore was developed from two foot contours derived from 2010 -2011 Lidar data courtesy of the USGS and the Maine Office of GIS.

This revision is based only on plans, deeds and other data supplied by the Town of South Bristol.
 Owner's names may be abbreviated, simplified, or omitted to save space. See South Bristol Tax Records for complete names.
 The dimensions and areas shown were derived from this map for assessment purposes only. They may be different from previous tax maps, deeds, or surveys.

**For Assessment Purposes Only
 Not a Boundary Survey
 Not To Be Used For
 Conveyances**

prepared by:
 Roderick H. Craib, Jr.
 Professional Land Surveyor # 1191
 174 Fox Hill Road
 Walpole, ME 04573
 Revisions dated April 1, 2026
 Maps printed April 29, 2026

Map 24

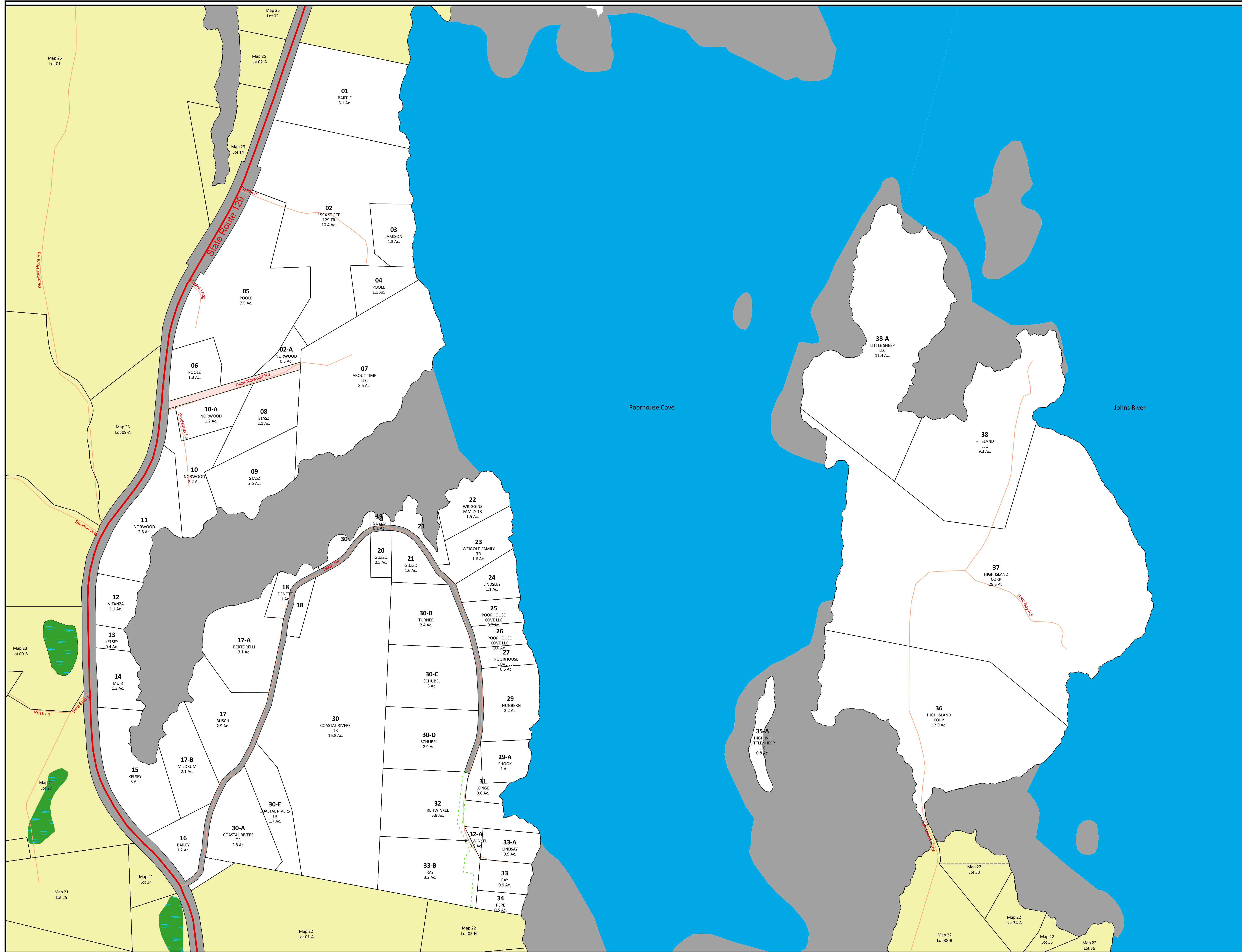

Property Map South Bristol Maine

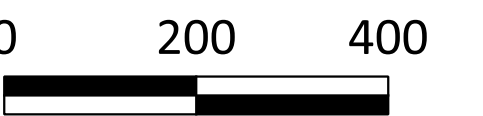
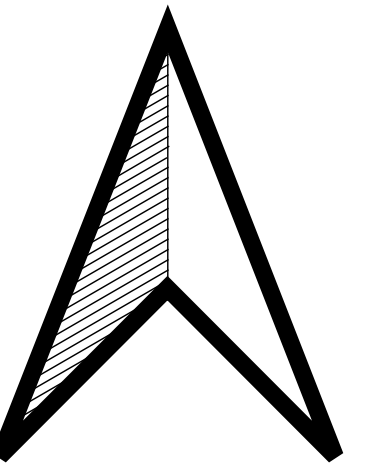

Scale:
1" = 200 ft.

Legend

- Parcels**
- This Map
 - Adjacent Maps
 - Private Roads
 - Public Roads
 - Easements
 - Subparcel lines
 - 911_Roads
 - Secondary
 - Local
 - Private
 - Streams
 - NWI_Wetlands
 - Fresh Water Bodies
 - Intertidal Flats and Ledges
 - Tidal Waters

Source Documents:
 South Bristol Property Maps by James W. Sewall Co. and updated through 2014 by Maine Coast Surveying.
 Digital Property Maps prepared by Maine Coast Surveying in 2014 and updated through 2016.
 Digital Property Map updates by Maine Coast Surveying & Flood Consulting 2017 & 2018.
 Digital Property Map updates by Roderick H. Craib, Jr. (PLS 1191) 2019 - 2025.
 Maine Office of Geographic Information Systems digital data layers include:
 High resolution digital orthophotographs produced from aerial photos collected in the Spring of 2013 and 2018.
 Road Type contains Next Generation 9-1-1 road centerline and road name data last updated April 7, 2025.
 Streams depicts single line streams of Maine from USGS 1:24,000 scale quadrangles.
 Wetlands (NWI) contains USFW National Wetland Inventory polygon data for Maine at 1:24,000 scale.
 The tidal shore was developed from two foot contours derived from 2010 -2011 Lidar data courtesy of the USGS and the Maine Office of GIS.

This revision is based only on plans, deeds and other data supplied by the Town of South Bristol.
 Owner's names may be abbreviated, simplified, or omitted to save space. See South Bristol Tax Records for complete names.
 The dimensions and areas shown were derived from this map for assessment purposes only. They may be different from previous tax maps, deeds, or surveys.

**For Assessment Purposes Only
 Not a Boundary Survey
 Not To Be Used For
 Conveyances**

prepared by:
 Roderick H. Craib, Jr.
 Professional Land Surveyor # 1191
 174 Fox Hill Road
 Walpole, ME 04573
 Revisions dated April 1, 2026
 Maps printed April 29, 2026

Map 25

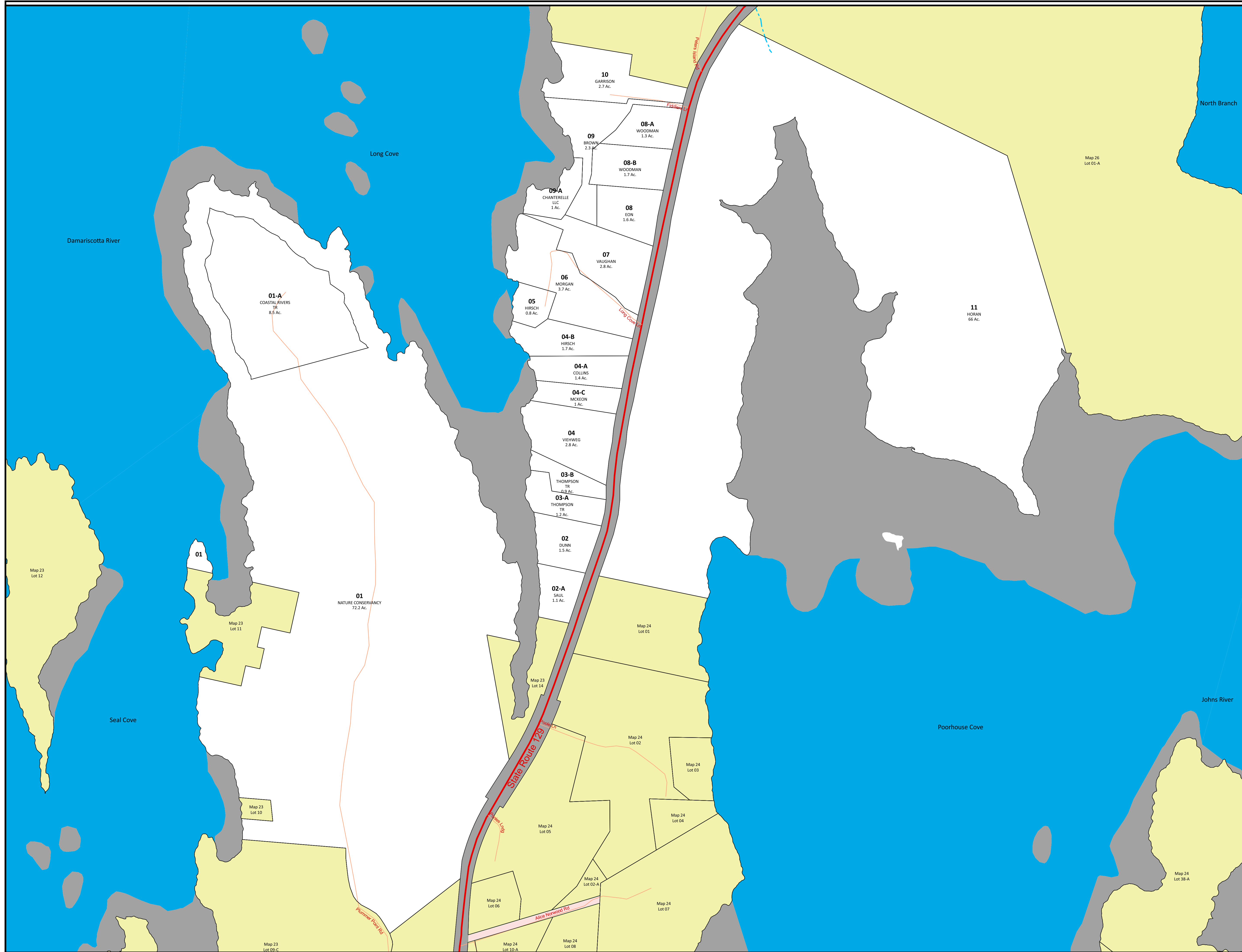

Property Map South Bristol Maine

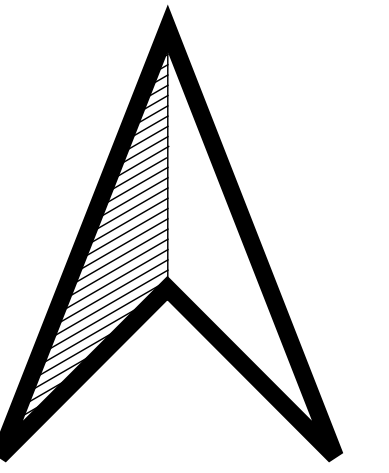

0 500 1,000

Scale:
1" = 400 ft.

Legend

- Parcels**
- This Map
 - Adjacent Maps
 - Private Roads
 - Public Roads
 - easements
 - Subparcel lines
 - 911_Roads
 - Secondary
 - Local
 - Private
 - Streams
 - NWI_Wetlands
 - Fresh Water Bodies
 - Intertidal Flats and Ledges
 - Tidal Waters

Source Documents:
 South Bristol Property Maps by James W. Sewall Co. and updated through 2014 by Maine Coast Surveying.
 Digital Property Maps prepared by Maine Coast Surveying in 2014 and updated through 2016.
 Digital Property Map updates by Maine Coast Surveying & Flood Consulting 2017 & 2018.
 Digital Property Map updates by Roderick H. Craib, Jr. (PLS 1191) 2019 - 2025.
 Maine Office of Geographic Information Systems digital data layers include:
 High resolution digital orthophotographs produced from aerial photos collected in the Spring of 2013 and 2018.
 Road Type contains Next Generation 9-1-1 road centerline and road name data last updated April 7, 2025.
 Streams depicts single line streams of Maine from USGS 1:24,000 scale quadrangles.
 Wetlands (NWI) contains USFW National Wetland Inventory polygon data for Maine at 1:24,000 scale.
 The tidal shore was developed from two foot contours derived from 2010 - 2011 Lidar data courtesy of the USGS and the Maine Office of GIS.
 This revision is based only on plans, deeds and other data supplied by the Town of South Bristol.
 Owner's names may be abbreviated, simplified, or omitted to save space. See South Bristol Tax Records for complete names.
 The dimensions and areas shown were derived from this map for assessment purposes only. They may be different from previous tax maps, deeds, or surveys.

**For Assessment Purposes Only
 Not a Boundary Survey
 Not To Be Used For
 Conveyances**

prepared by:
 Roderick H. Craib, Jr.
 Professional Land Surveyor # 1191
 174 Fox Hill Road
 Walpole, ME 04573
 Revisions dated April 1, 2026
 Maps printed April 29, 2026

Map 26

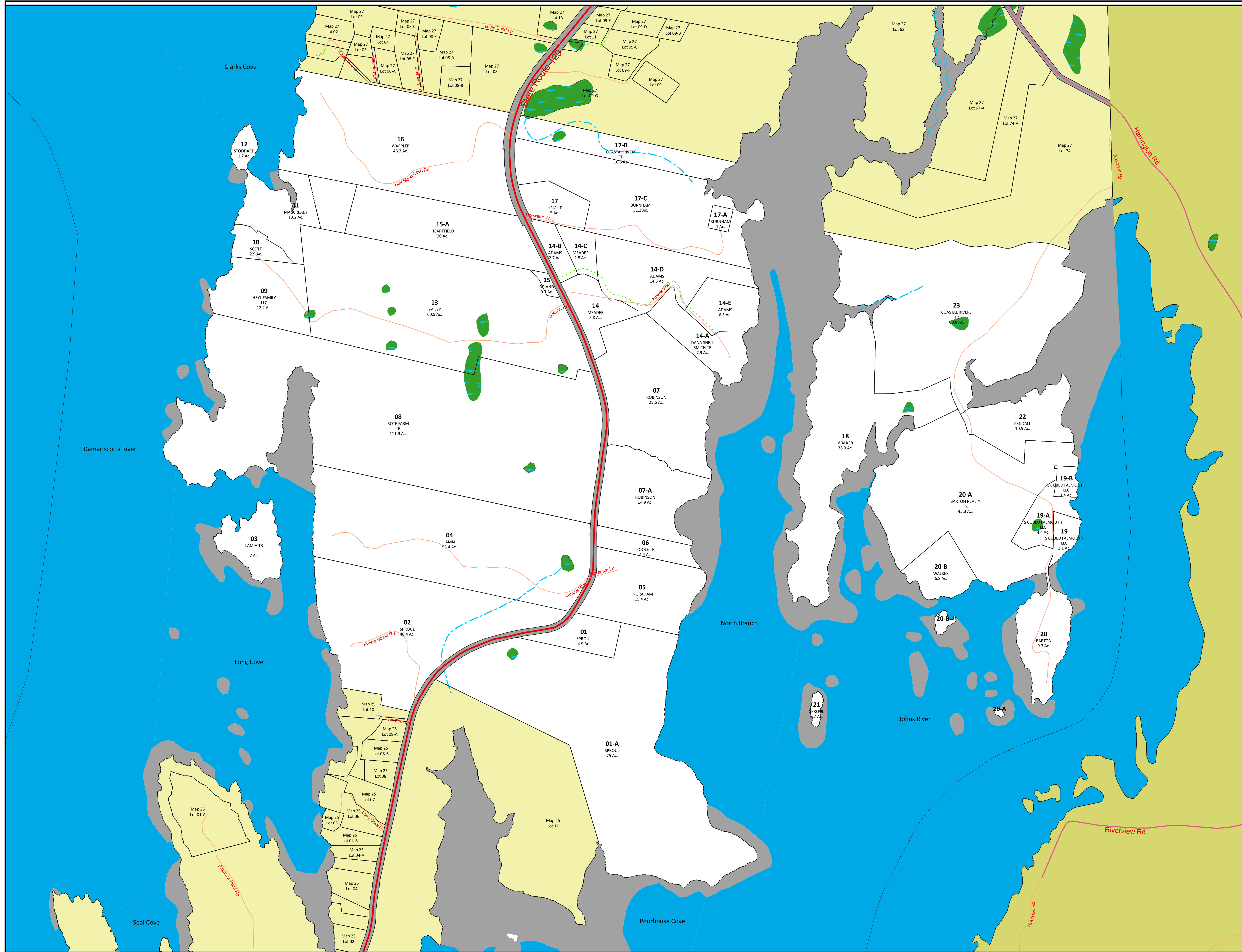

Property Map South Bristol Maine

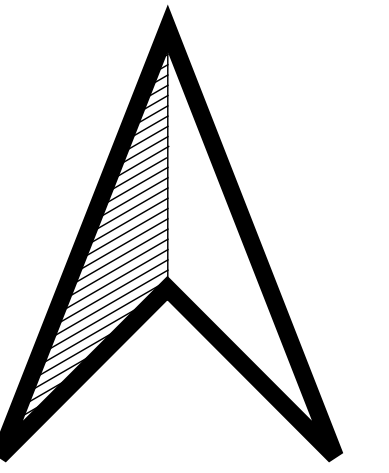

0 500 1,000

Scale:
1" = 400 ft.

Legend

- Parcels
- This Map
- Adjacent Maps
- Private Roads
- Public Roads
- es easements
- Subparcel lines
- 911_Roads
- Secondary
- Local
- Private
- Streams
- NWI_Wetlands
- Fresh Water Bodies
- Intertidal Flats and Ledges
- Tidal Waters

Source Documents:
 South Bristol Property Maps by James W. Sewall Co. and updated through 2014 by Maine Coast Surveying.
 Digital Property Maps prepared by Maine Coast Surveying in 2014 and updated through 2016.
 Digital Property Map updates by Maine Coast Surveying & Flood Consulting 2017 & 2018.
 Digital Property Map updates by Roderick H. Craib, Jr. (PLS 1191) 2019 - 2025.
 Maine Office of Geographic Information Systems digital data layers include:
 High resolution digital orthophotographs produced from aerial photos collected in the Spring of 2013 and 2018.
 Road Type contains Next Generation 9-1-1 road centerline and road name data last updated April 7, 2025.
 Streams depicts single line streams of Maine from USGS 1:24,000 scale quadrangles.
 Wetlands (NWI) contains USFW National Wetland Inventory polygon data for Maine at 1:24,000 scale.
 The tidal shore was developed from two foot contours derived from 2010 - 2011 Lidar data courtesy of the USGS and the Maine Office of GIS.

This revision is based only on plans, deeds and other data supplied by the Town of South Bristol.
 Owner's names may be abbreviated, simplified, or omitted to save space. See South Bristol Tax Records for complete names.
 The dimensions and areas shown were derived from this map for assessment purposes only. They may be different from previous tax maps, deeds, or surveys.

**For Assessment Purposes Only
 Not a Boundary Survey
 Not To Be Used For
 Conveyances**

prepared by:
 Roderick H. Craib, Jr.
 Professional Land Surveyor # 1191
 174 Fox Hill Road
 Walpole, ME 04573
 Revisions dated April 1, 2026
 Maps printed April 29, 2026

Map 27

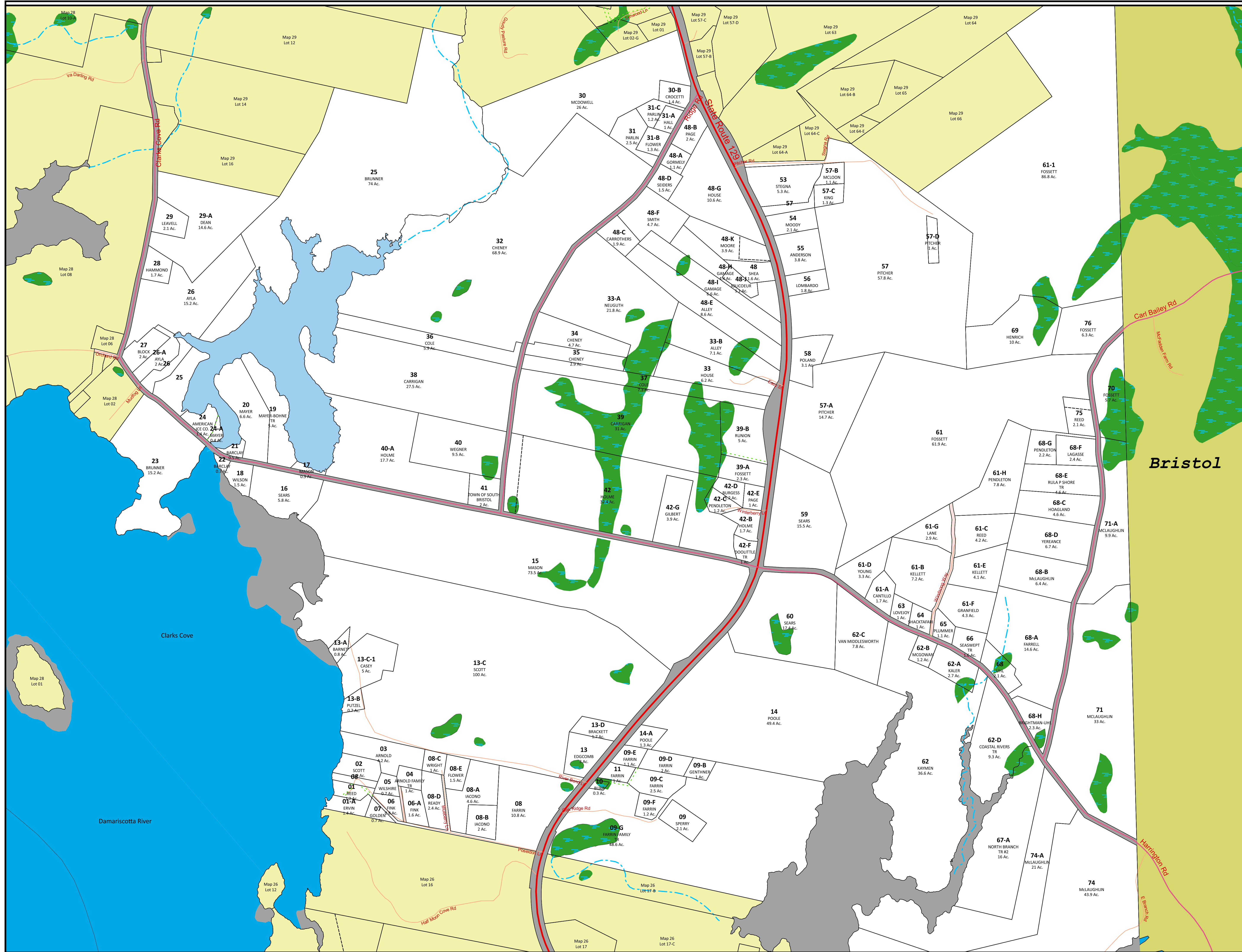

Property Map South Bristol Maine

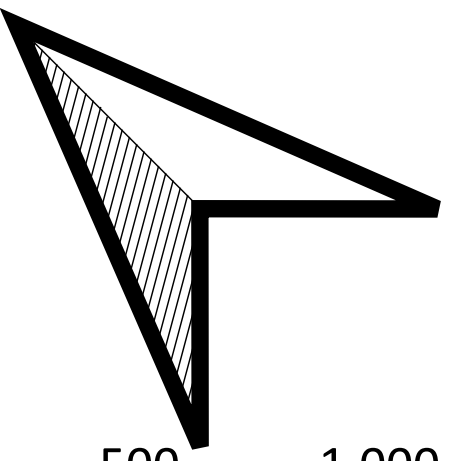

0 500 1,000

Scale:
1" = 400 ft.

Legend

- Parcels**
- This Map
 - Adjacent Maps
 - Private Roads
 - Public Roads
 - Easements
 - Subparcel lines
 - 911_Roads
 - Secondary
 - Local
 - Private
 - Streams
 - NWI_Wetlands
 - Fresh Water Bodies
 - Intertidal Flats and Ledges
 - Tidal Waters

Source Documents:

South Bristol Property Maps by James W. Sewall Co. and updated through 2014 by Maine Coast Surveying.

Digital Property Maps prepared by Maine Coast Surveying in 2014 and updated through 2016.

Digital Property Map updates by Maine Coast Surveying & Flood Consulting 2017 & 2018.

Digital Property Map updates by Roderick H. Craib, Jr. (PLS 1191) 2019 - 2025.

Maine Office of Geographic Information Systems digital data layers include:

- High resolution digital orthophotographs produced from aerial photos collected in the Spring of 2013 and 2018.
- Road Type contains Next Generation 9-1-1 road centerline and road name data last updated April 7, 2025.
- Streams depicts single line streams of Maine from USGS 1:24,000 scale quadrangles.
- Wetlands (NWI) contains USFW National Wetland Inventory polygon data for Maine at 1:24,000 scale.
- The tidal shore was developed from two foot contours derived from 2010 -2011 Lidar data courtesy of the USGS and the Maine Office of GIS.

This revision is based only on plans, deeds and other data supplied by the Town of South Bristol.

Owner's names may be abbreviated, simplified, or omitted to save space. See South Bristol Tax Records for complete names.

The dimensions and areas shown were derived from this map for assessment purposes only. They may be different from previous tax maps, deeds, or surveys.

**For Assessment Purposes Only
Not a Boundary Survey
Not To Be Used For
Conveyances**

prepared by:
Roderick H. Craib, Jr.
Professional Land Surveyor # 1191
174 Fox Hill Road
Walpole, ME 04573

Revisions dated April 1, 2026
Maps printed April 29, 2026

Map 28

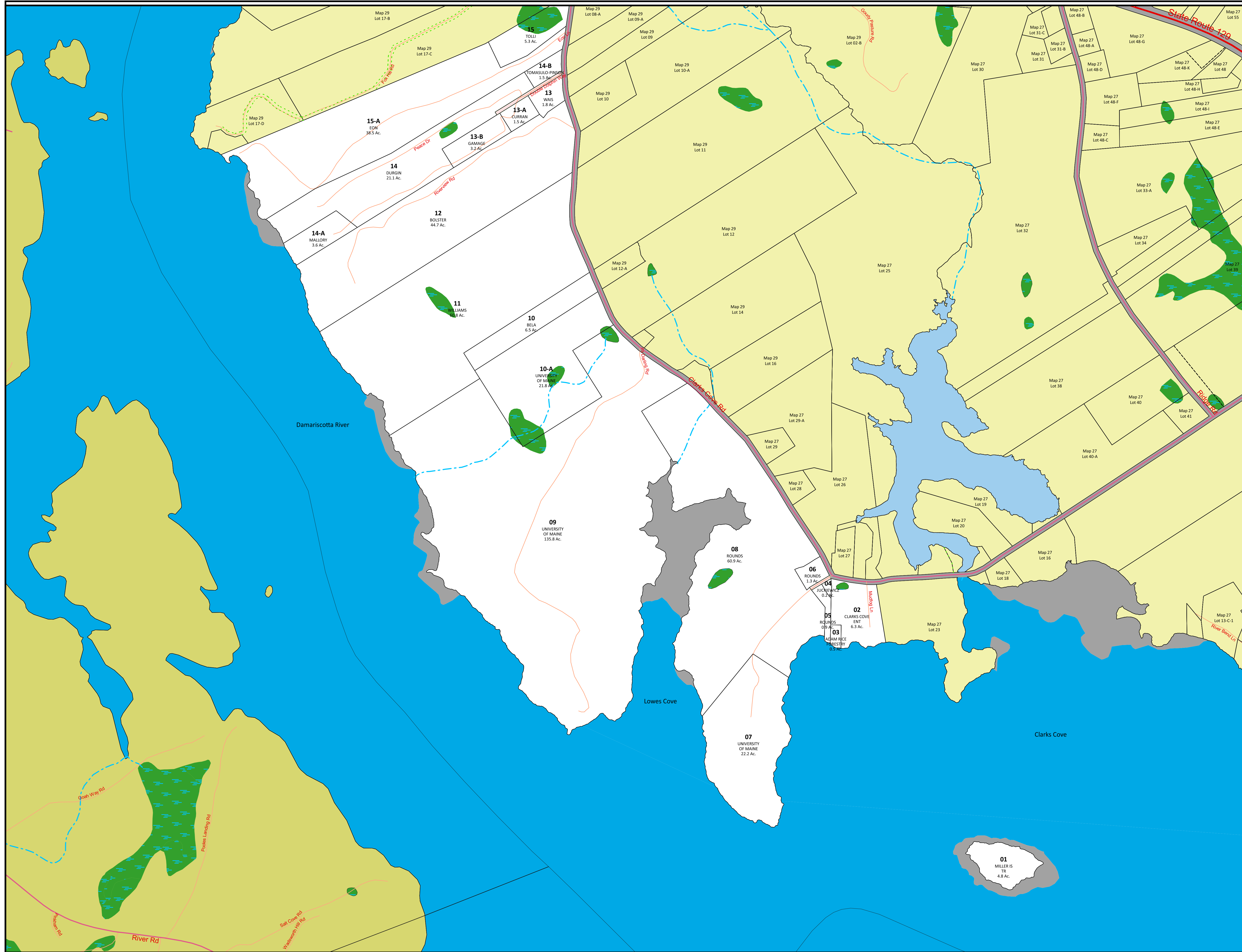

Property Map South Bristol Maine

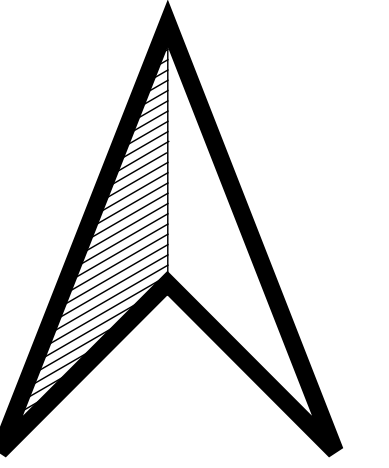

0 500 1,000

Scale:
1" = 400 ft.

Legend

- Parcels**
- This Map
 - Adjacent Maps
 - Private Roads
 - Public Roads
 - Easements
 - Subparcel lines
 - 911_Roads
 - Secondary
 - Local
 - Private
 - Streams
 - NWI_Wetlands
 - Fresh Water Bodies
 - Intertidal Flats and Ledges
 - Tidal Waters

Source Documents:
 South Bristol Property Maps by James W. Sewall Co. and updated through 2014 by Maine Coast Surveying.
 Digital Property Maps prepared by Maine Coast Surveying in 2014 and updated through 2016.
 Digital Property Map updates by Maine Coast Surveying & Flood Consulting 2017 & 2018.
 Digital Property Map updates by Roderick H. Craib, Jr. (PLS 1191) 2019 - 2025.
 Maine Office of Geographic Information Systems digital data layers include:
 High resolution digital orthophotographs produced from aerial photos collected in the Spring of 2013 and 2018.
 Road Type contains Next Generation 9-1-1 road centerline and road name data last updated April 7, 2025.
 Streams depicts single line streams of Maine from USGS 1:24,000 scale quadrangles.
 Wetlands (NWI) contains USFW National Wetland Inventory polygon data for Maine at 1:24,000 scale.
 The tidal shore was developed from two foot contours derived from 2010 -2011 Lidar data courtesy of the USGS and the Maine Office of GIS.

This revision is based only on plans, deeds and other data supplied by the Town of South Bristol.

Owner's names may be abbreviated, simplified, or omitted to save space. See South Bristol Tax Records for complete names.

The dimensions and areas shown were derived from this map for assessment purposes only. They may be different from previous tax maps, deeds, or surveys.

**For Assessment Purposes Only
 Not a Boundary Survey
 Not To Be Used For
 Conveyances**

prepared by:
 Roderick H. Craib, Jr.
 Professional Land Surveyor # 1191
 174 Fox Hill Road
 Walpole, ME 04573

Revisions dated April 1, 2026
 Maps printed April 29, 2026

Map 29

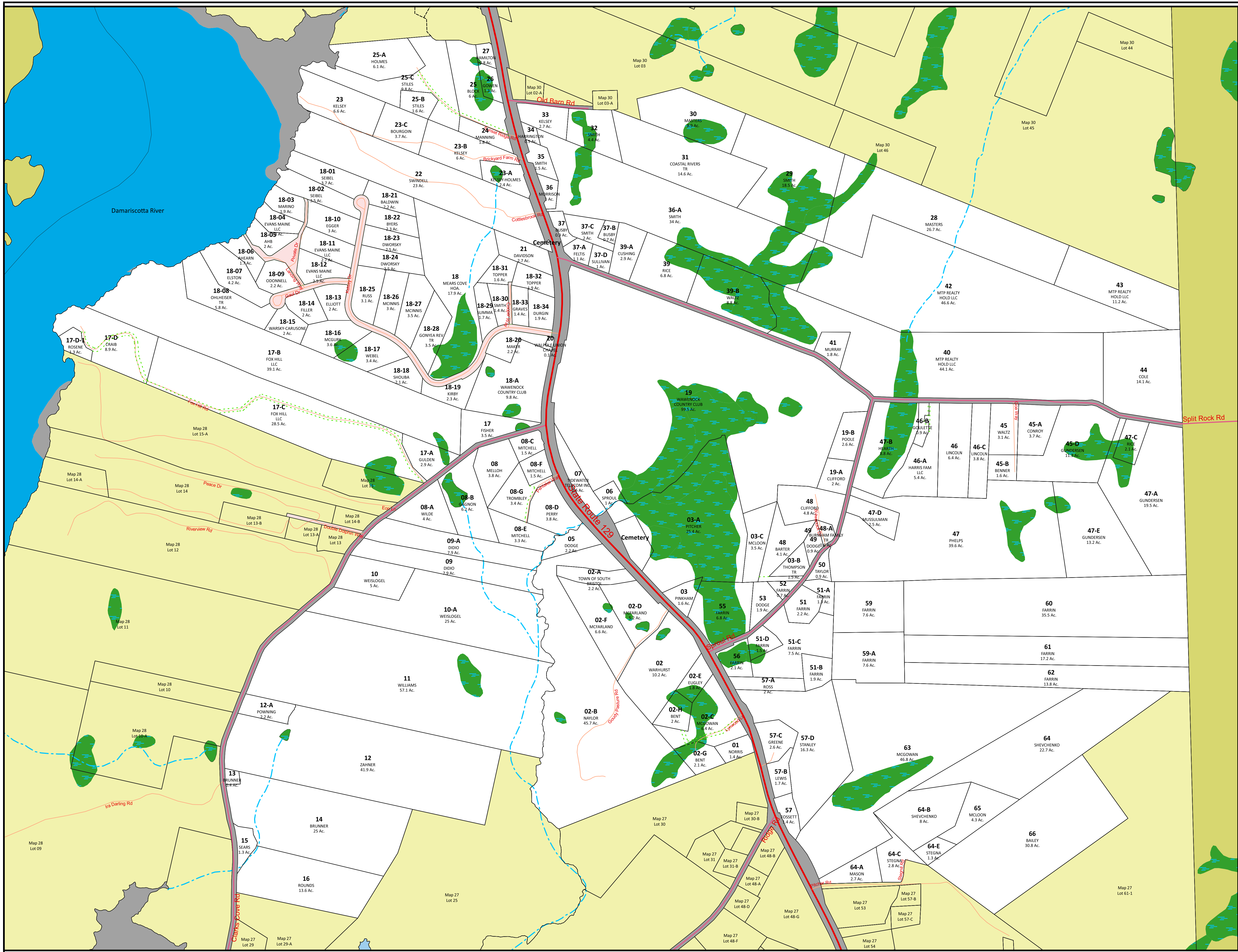

Property Map South Bristol Maine

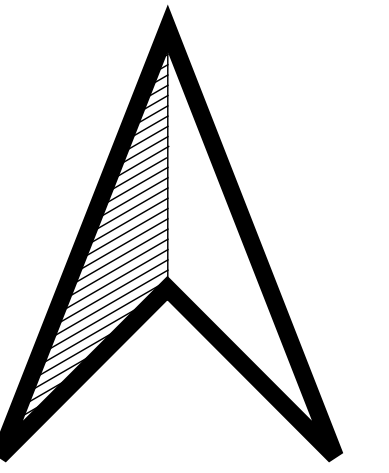

0 500 1,000

Scale:
1" = 400 ft.

Legend

- Parcels**
- This Map
 - Adjacent Maps
 - Private Roads
 - Public Roads
 - Easements
 - Subparcel lines
 - 911_Roads
 - Secondary
 - Local
 - Private
 - Streams
 - NWI_Wetlands
 - Fresh Water Bodies
 - Intertidal Flats and Ledges
 - Tidal Waters

Source Documents:
 South Bristol Property Maps by James W. Sewall Co. and updated through 2014 by Maine Coast Surveying.
 Digital Property Maps prepared by Maine Coast Surveying in 2014 and updated through 2016.
 Digital Property Map updates by Maine Coast Surveying & Flood Consulting 2017 & 2018.
 Digital Property Map updates by Roderick H. Craib, Jr. (PLS 1191) 2019 - 2025.
 Maine Office of Geographic Information Systems digital data layers include:
 High resolution digital orthophotographs produced from aerial photos collected in the Spring of 2013 and 2018.
 Road Type contains Next Generation 9-1-1 road centerline and road name data last updated April 7, 2025.
 Streams depicts single line streams of Maine from USGS 1:24,000 scale quadrangles.
 Wetlands (NWI) contains USFW National Wetland Inventory polygon data for Maine at 1:24,000 scale.
 The tidal shore was developed from two foot contours derived from 2010 - 2011 Lidar data courtesy of the USGS and the Maine Office of GIS.

This revision is based only on plans, deeds and other data supplied by the Town of South Bristol.
 Owner's names may be abbreviated, simplified, or omitted to save space. See South Bristol Tax Records for complete names.
 The dimensions and areas shown were derived from this map for assessment purposes only. They may be different from previous tax maps, deeds, or surveys.

**For Assessment Purposes Only
 Not a Boundary Survey
 Not To Be Used For
 Conveyances**

prepared by:
 Roderick H. Craib, Jr.
 Professional Land Surveyor # 1191
 174 Fox Hill Road
 Walpole, ME 04573
 Revisions dated April 1, 2026
 Maps printed April 29, 2026

Map 30

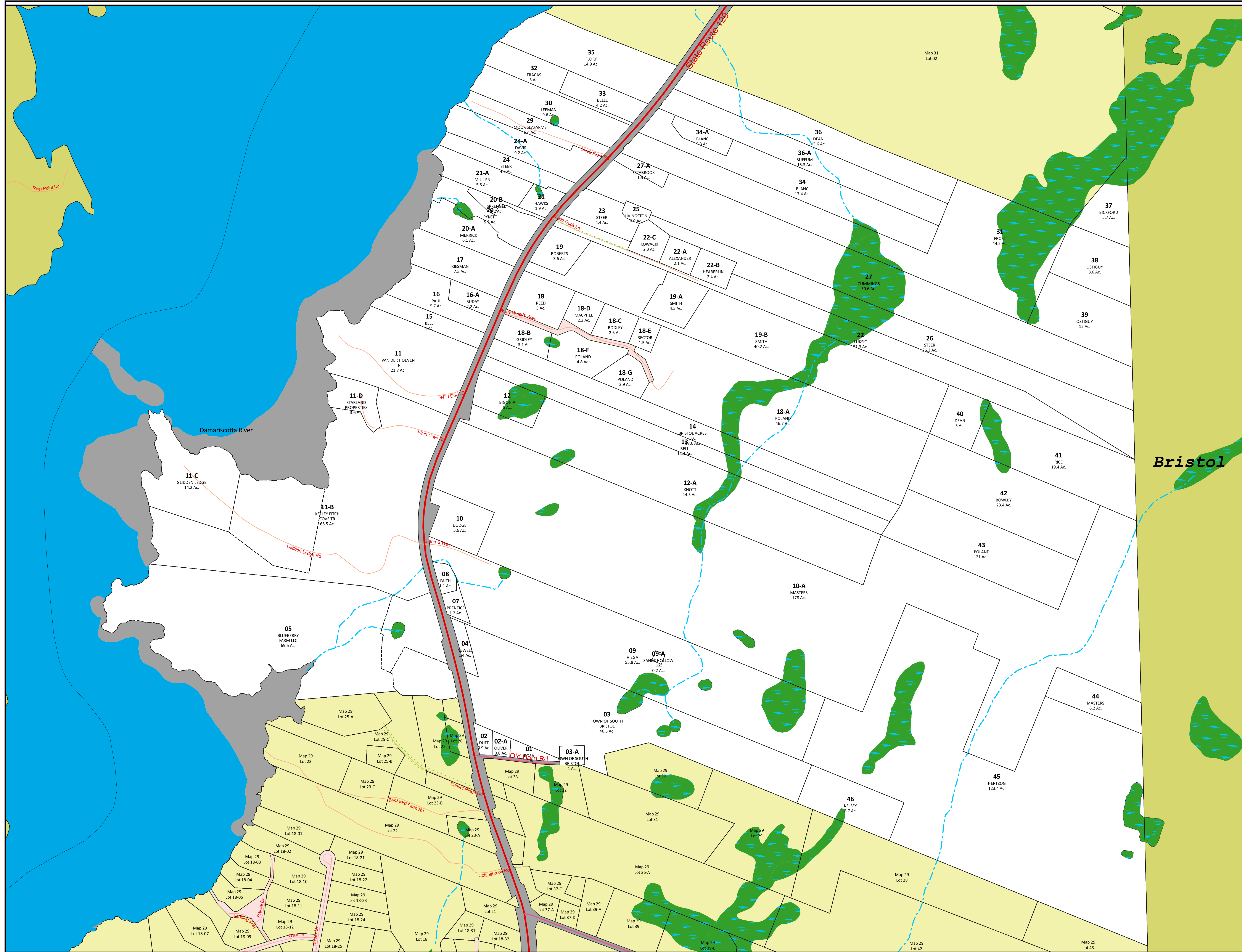

Property Map South Bristol Maine

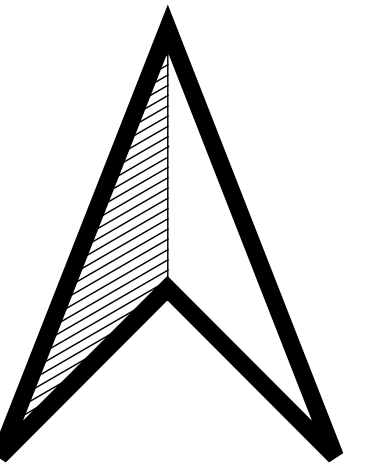

0 500 1,000

Scale:
1" = 400 ft.

Legend

- Parcels**
- This Map
 - Adjacent Maps
 - Private Roads
 - Public Roads
 - Easements
 - Subparcel lines
 - 911_Roads
 - Secondary
 - Local
 - Private
 - Streams
 - NWI_Wetlands
 - Fresh Water Bodies
 - Intertidal Flats and Ledges
 - Tidal Waters

Source Documents:
 South Bristol Property Maps by James W. Sewall Co. and updated through 2014 by Maine Coast Surveying.
 Digital Property Maps prepared by Maine Coast Surveying in 2014 and updated through 2016.
 Digital Property Map updates by Maine Coast Surveying & Flood Consulting 2017 & 2018.
 Digital Property Map updates by Roderick H. Craib, Jr. (PLS 1191) 2019 - 2025.
 Maine Office of Geographic Information Systems digital data layers include:
 High resolution digital orthophotographs produced from aerial photos collected in the Spring of 2013 and 2018.
 Road Type contains Next Generation 9-1-1 road centerline and road name data last updated April 7, 2026.
 Streams depicts single line streams of Maine from USGS 1:24,000 scale quadrangles.
 Wetlands (NWI) contains USFW National Wetland Inventory polygon data for Maine at 1:24,000 scale.
 The tidal shore was developed from two foot contours derived from 2010 -2011 Lidar data courtesy of the USGS and the Maine Office of GIS.

This revision is based only on plans, deeds and other data supplied by the Town of South Bristol.
 Owner's names may be abbreviated, simplified, or omitted to save space. See South Bristol Tax Records for complete names.
 The dimensions and areas shown were derived from this map for assessment purposes only. They may be different from previous tax maps, deeds, or surveys.

**For Assessment Purposes Only
 Not a Boundary Survey
 Not To Be Used For
 Conveyances**

prepared by:
 Roderick H. Craib, Jr.
 Professional Land Surveyor # 1191
 174 Fox Hill Road
 Walpole, ME 04573
 Revisions dated April 1, 2026
 Maps printed April 29, 2026

Map 31

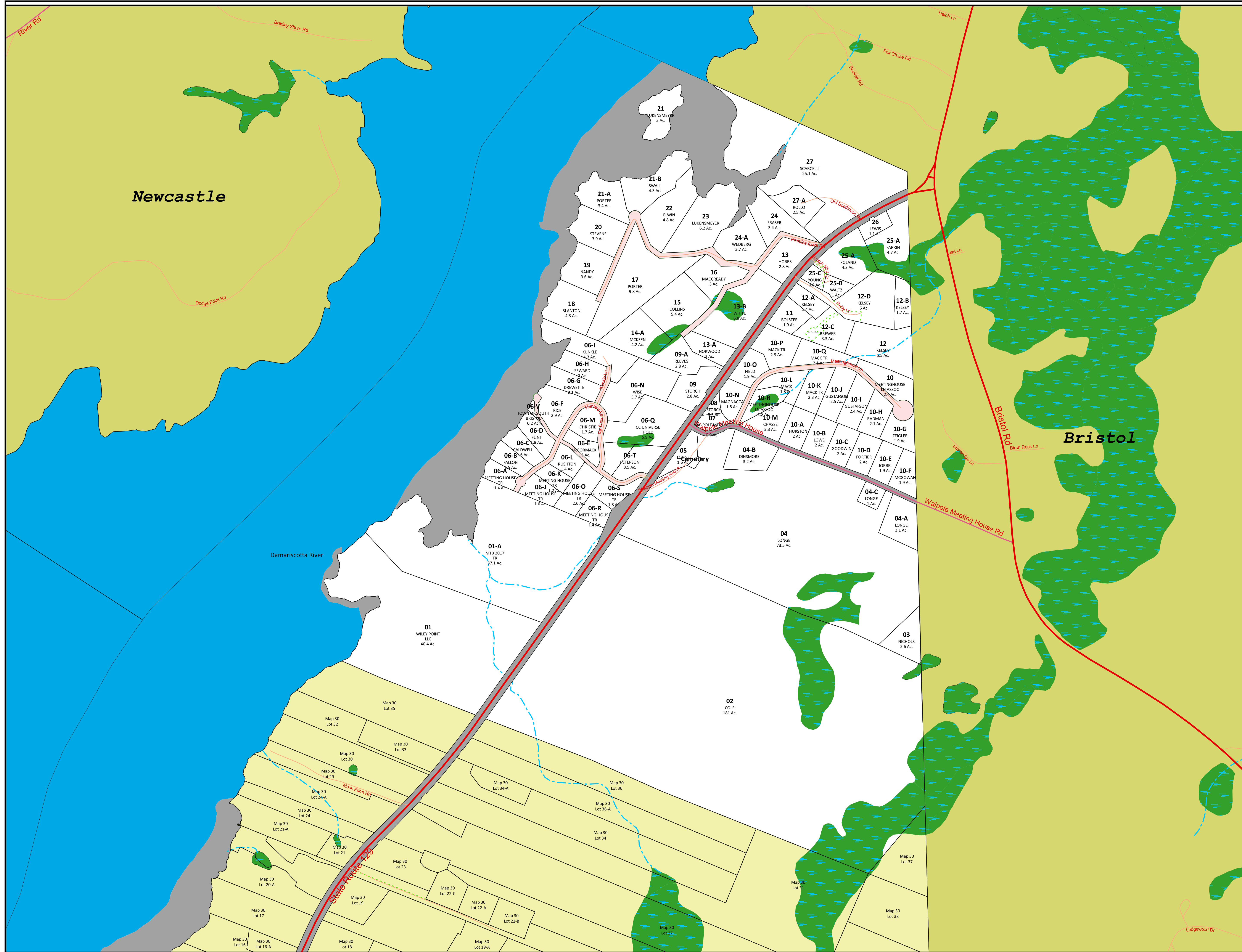

Newcastle

Bristol

Damariscotta River

Cemetery

Map 30 Lot 35
 Map 30 Lot 32
 Map 30 Lot 33
 Map 30 Lot 29
 Map 30 Lot 28-A
 Map 30 Lot 24
 Map 30 Lot 21-A
 Map 30 Lot 20-A
 Map 30 Lot 17
 Map 30 Lot 16
 Map 30 Lot 16-A
 Map 30 Lot 18
 Map 30 Lot 19
 Map 30 Lot 22-C
 Map 30 Lot 22-A
 Map 30 Lot 22-B
 Map 30 Lot 19-A
 Map 30 Lot 36
 Map 30 Lot 36-A
 Map 30 Lot 34
 Map 30 Lot 31
 Map 30 Lot 38

01 WILEY POINT LLC 40.4 Ac.

02 COLE 181 Ac.

03 NICHOLS 2.6 Ac.

21 LUKENMEYER 3 Ac.

21-A PORTER 3.8 Ac.

21-B SWALL 4.3 Ac.

22 ELIWHI 4.8 Ac.

23 LUKENMEYER 6.2 Ac.

24 FRASER 3.4 Ac.

24-A WEDBERG 3.7 Ac.

13 HOBBS 2.8 Ac.

25-A POLAND 4.3 Ac.

25 LUCAS 1.1 Ac.

25-A FARRIN 4.7 Ac.

19 NANDY 3.6 Ac.

17 PORTER 9.8 Ac.

18 BLANTON 4.3 Ac.

15 COLLINS 5.4 Ac.

14-A MCKEEN 4.2 Ac.

09-A REEVES 2.8 Ac.

06-I KUNKLE 4.2 Ac.

06-H SEWARD 2.4 Ac.

06-G DREWETTE 2.4 Ac.

06-N WISE 5.7 Ac.

06-V RICE 2.9 Ac.

06-F BRISKIN 0.2 Ac.

06-D FLINT 3.8 Ac.

06-M CHRISTIE 1.7 Ac.

06-Q CC UNIVERSE 5.9 Ac.

06-L RUSHITON 1.4 Ac.

06-K FALLOM 2.4 Ac.

06-T PETERSON 3.5 Ac.

06-O MEETING HOUSE TR 1.8 Ac.

06-S MEETING HOUSE TR 2.6 Ac.

06-R MEETING HOUSE TR 1.7 Ac.

12-A KELSEY 6 Ac.

12-C BREWER 3.3 Ac.

12-D KELSEY 1.7 Ac.

12-B KELSEY 1.7 Ac.

10-MEETINGHOUSE IN ASSOC 7.8 Ac.

10-K MACK TR 2.3 Ac.

10-J GUSTAFSON 2.4 Ac.

10-I RADMAN 2.1 Ac.

10-H KELSEY 1.9 Ac.

10-G ZEIGLER 1.9 Ac.

10-F MCCOWAN 1.9 Ac.

10-E FORTIER 2 Ac.

10-D JORBEL 1.9 Ac.

10-C GOODWIN 2 Ac.

10-A THURSTON 2 Ac.

10-B LOWE 2 Ac.

10-K MACK TR 2.3 Ac.

10-L MACK TR 1.9 Ac.

10-N MACK TR 1.8 Ac.

10-O FIELD 1.9 Ac.

10-P MACK TR 2.9 Ac.

10-Q MACK TR 2.1 Ac.

10-R MACK TR 1.3 Ac.

10-M CHASSE 2.3 Ac.

04-B DINSMORE 3.2 Ac.

04-A LONGE 3.1 Ac.

04-C LONGE 1 Ac.

04-A LONGE 3.1 Ac.

04-A LONGE 3.1 Ac.

04-A LONGE 3.1 Ac.

04-A LONGE 3.1 Ac.

04-A LONGE 3.1 Ac.

04-A LONGE 3.1 Ac.

04-A LONGE 3.1 Ac.

04-A LONGE 3.1 Ac.

04-A LONGE 3.1 Ac.

04-A LONGE 3.1 Ac.

04-A LONGE 3.1 Ac.

04-A LONGE 3.1 Ac.

04-A LONGE 3.1 Ac.

04-A LONGE 3.1 Ac.

04-A LONGE 3.1 Ac.

04-A LONGE 3.1 Ac.

04-A LONGE 3.1 Ac.

04-A LONGE 3.1 Ac.

04-A LONGE 3.1 Ac.

04-A LONGE 3.1 Ac.

04-A LONGE 3.1 Ac.

04-A LONGE 3.1 Ac.

04-A LONGE 3.1 Ac.

04-A LONGE 3.1 Ac.

04-A LONGE 3.1 Ac.

04-A LONGE 3.1 Ac.

04-A LONGE 3.1 Ac.

04-A LONGE 3.1 Ac.

04-A LONGE 3.1 Ac.

04-A LONGE 3.1 Ac.

04-A LONGE 3.1 Ac.

04-A LONGE 3.1 Ac.

04-A LONGE 3.1 Ac.

04-A LONGE 3.1 Ac.

04-A LONGE 3.1 Ac.

04-A LONGE 3.1 Ac.

04-A LONGE 3.1 Ac.

04-A LONGE 3.1 Ac.

04-A LONGE 3.1 Ac.

04-A LONGE 3.1 Ac.

04-A LONGE 3.1 Ac.

04-A LONGE 3.1 Ac.

04-A LONGE 3.1 Ac.

04-A LONGE 3.1 Ac.

04-A LONGE 3.1 Ac.

04-A LONGE 3.1 Ac.

04-A LONGE 3.1 Ac.

04-A LONGE 3.1 Ac.

04-A LONGE 3.1 Ac.

04-A LONGE 3.1 Ac.

04-A LONGE 3.1 Ac.

04-A LONGE 3.1 Ac.

04-A LONGE 3.1 Ac.

04-A LONGE 3.1 Ac.

04-A LONGE 3.1 Ac.

04-A LONGE 3.1 Ac.

04-A LONGE 3.1 Ac.

04-A LONGE 3.1 Ac.

04-A LONGE 3.1 Ac.

04-A LONGE 3.1 Ac.

04-A LONGE 3.1 Ac.

04-A LONGE 3.1 Ac.

04-A LONGE 3.1 Ac.

04-A LONGE 3.1 Ac.

04-A LONGE 3.1 Ac.

04-A LONGE 3.1 Ac.

04-A LONGE 3.1 Ac.

04-A LONGE 3.1 Ac.

04-A LONGE 3.1 Ac.

04-A LONGE 3.1 Ac.

04-A LONGE 3.1 Ac.

04-A LONGE 3.1 Ac.

04-A LONGE 3.1 Ac.

04-A LONGE 3.1 Ac.

04-A LONGE 3.1 Ac.

04-A LONGE 3.1 Ac.

04-A LONGE 3.1 Ac.

04-A LONGE 3.1 Ac.

04-A LONGE 3.1 Ac.

04-A LONGE 3.1 Ac.

04-A LONGE 3.1 Ac.

04-A LONGE 3.1 Ac.

04-A LONGE 3.1 Ac.

04-A LONGE 3.1 Ac.

04-A LONGE 3.1 Ac.

04-A LONGE 3.1 Ac.

04-A LONGE 3.1 Ac.

04-A LONGE 3.1 Ac.

04-A LONGE 3.1 Ac.

04-A LONGE 3.1 Ac.

04-A LONGE 3.1 Ac.

04-A LONGE 3.1 Ac.

04-A LONGE 3.1 Ac.

04-A LONGE 3.1 Ac.

04-A LONGE 3.1 Ac.

04-A LONGE 3.1 Ac.

04-A LONGE 3.1 Ac.

04-A LONGE 3.1 Ac.

04-A LONGE 3.1 Ac.

04-A LONGE 3.1 Ac.

04-A LONGE 3.1 Ac.

04-A LONGE 3.1 Ac.

04-A LONGE 3.1 Ac.

04-A LONGE 3.1 Ac.

04-A LONGE 3.1 Ac.

04-A LONGE 3.1 Ac.

04-A LONGE 3.1 Ac.

04-A LONGE 3.1 Ac.

04-A LONGE 3.1 Ac.

04-A LONGE 3.1 Ac.

04-A LONGE 3.1 Ac.

04-A LONGE 3.1 Ac.

04-A LONGE 3.1 Ac.

04-A LONGE 3.1 Ac.

04-A LONGE 3.1 Ac.

04-A LONGE 3.1 Ac.

04-A LONGE 3.1 Ac.

04-A LONGE 3.1 Ac.

04-A LONGE 3.1 Ac.

04-A LONGE 3.1 Ac.

04-A LONGE 3.1 Ac.

04-A LONGE 3.1 Ac.

04-A LONGE 3.1 Ac.

04-A LONGE 3.1 Ac.

04-A LONGE 3.1 Ac.

04-A LONGE 3.1 Ac.

04-A LONGE 3.1 Ac.

04-A LONGE 3.1 Ac.

04-A LONGE 3.1 Ac.

04-A LONGE 3.1 Ac.

04-A LONGE 3.1 Ac.

04-A LONGE 3.1 Ac.

04-A LONGE 3.1 Ac.

04-A LONGE 3.1 Ac.

04-A LONGE 3.1 Ac.

04-A LONGE 3.1 Ac.

04-A LONGE 3.1 Ac.

04-A LONGE 3.1 Ac.

04-A LONGE 3.1 Ac.

04-A LONGE 3.1 Ac.